

**Ersatzteilverzeichnis**  
**Spare Parts List**

**P30/36-150D 105°C**  
**P30/43-130D 105°C**

**Best.-Nr.: 00.2130**  
**Code Nr. 00.2131**

| Lfd. Nr.<br>Item No. | Stückzahl<br>No. Off | Best.-Nr.<br>Code No. | Benennung  | Description                                       |
|----------------------|----------------------|-----------------------|--|---|
| 1                    | 1                    | 01.0255               | Antriebsgehäuse                                    | Crankcase   |
| 2                    | 1                    | 00.2431               | Ölauffüllstopfen kpl.                              | Oil Filler Plug Assy                              |
| 3                    | 1                    | 03.0162               | Getriebedeckel                                     | Crankcase Cover                                   |
| 4                    | 1                    | 06.0286               | O-Ring zu 3  | O-Ring for 3                                      |
| 5                    | 1                    | 00.0564               | Ölmeßstab kpl.                                     | Oil Dipstick Assy                                 |
| 6                    | 1                    | 06.0053               | O-Ring zu 5  | O-Ring for 5                                      |
| 7                    | 1                    | 00.2416               | Ölschauglas  | Oil Sight Glass                                   |
| 9                    | 4                    | 21.0026               | Zylinderschraube                                   | Cylinder Screw                                    |
| 10                   | 4                    | 07.2994               | Federring  | Spring Ring                                       |
| 11                   | 2                    | 07.0705               | Stopfen G1/2                                       | Plug G1/2   |
| 11A                  | 2                    | 06.0067               | O-Ring   | O-Ring  |
| 12                   | 2                    | 03.0163               | Lagerdeckel  | Bearing Cover                                     |
| 13                   | 2                    | 06.0288               | O-Ring   | O-Ring  |
| 14                   | 2                    | 06.0287               | Radialwellendichtring                              | Radial Shaft Seal                                 |
| 15                   | 2                    | 05.0101               | Rillenkugellager                                   | Grooved Ball Bearing                              |
| 16                   | 6                    | 21.0034               | Sechskantkombischraube                             | Hexagon Screw                                     |
| 17                   | 1                    | 07.4600               | Wellenschutz                                       | Shaft Protector                                   |
| 18                   | 1                    | 11.0258               | Kurbelwelle  | Crankshaft  |
| 19                   | 1                    | 07.3050               | Passfeder  | Fitting Key                                       |
| 20                   | 3                    | 00.3288               | Gleitlagerpleuel kpl.                              | Connecting Rod Assy                               |
| 22                   | 3                    | 00.0596               | Kreuzkopf kpl.                                     | Crosshead Assy                                    |
| 23                   | 3                    | 11.0259               | Kreuzkopfbolzen                                    | Crosshead Pin                                     |
| 24A                  | 3                    | 11.0271               | Plungerrohr P30/36-150D                            | Plunger Pipe P30/36-150D                          |
| 24A                  | 3                    | 11.0272               | Plungerrohr P30/43-130D                            | Plunger Pipe P30/43-130D                          |
| 24B                  | 3                    | 21.0338               | Spannschraube                                      | Tensioning Screw                                  |
| 24C                  | 3                    | 06.0113               | O-Ring   | O-Ring  |
| 24D                  | 3                    | 06.0114               | Stützring  | Support Ring                                      |
| 24E                  | 3                    | 06.0275               | Cu-Dichtring                                       | Copper Ring                                       |
| 25                   | 3                    | 07.4354               | Ölabstreifer                                       | Oil Scraper                                       |
| 26                   | 3                    | 06.1246               | Radialwellendichtring                              | Radial Shaft Seal                                 |
| 28                   | 2                    | 07.0874               | Zentrierhülse                                      | Seal Retainer                                     |
| 29*                  | 1                    | 01.0272               | Ventilgehäuse                                      | Valve Casing                                      |
| 29A                  | 2                    | 21.0287               | Gewindestift                                       | Stud Bolt   |
| 30                   | 3                    | 07.1581               | Druckring P30/36-150D                              | Pressure Ring P30/36-150D                         |
| 30                   | 3                    | 07.0924               | Druckring P30/43-130D                              | Pressure Ring P30/43-130D                         |
| 33                   | 3                    | 07.0918               | Druckfeder   | Pressure Spring                                   |
| ••34                 | 3                    | 07.4960               | Federspannschale                                   | Spring Tension Cap                                |
| ••34A                | 3                    | 07.1990               | Federspannschale Saug                              | Spring Tension Cap for Suction                    |
| ••35                 | 6                    | 07.2147               | Ventilfeder  | Valve Spring                                      |
| ••36                 | 6                    | 07.0957               | Ventilplatte                                       | Valve Plate                                       |
| ••37                 | 6                    | 07.0292               | Ventilsitz   | Valve Seat  |
| ••38                 | 6                    | 06.0067               | O-Ring   | O-Ring  |
| 39                   | 3                    | 07.0915               | Saugventilaufnahme                                 | Suction Valve Adaptor                             |
| 39A                  | 3                    | 07.0916               | Distanzring  | Spacer Ring                                       |
| o•40                 | 3                    | 06.0255               | O-Ring   | O-Ring  |
| 41                   | 3                    | 07.0912               | Stopfen M36x1.5                                    | Plug M36x1.5                                      |
| o•42                 | 3                    | 06.0285               | O-Ring   | O-Ring  |
| 43                   | 3                    | 07.0814               | Stopfen M30x1.5                                    | Plug M30x1.5                                      |
| o•44                 | 3                    | 06.0251               | O-Ring   | O-Ring  |
| 45                   | 4                    | 21.0074               | Stiftschraube                                      | Stud Bolt   |
| 46                   | 4                    | 07.0988               | Sechskantmutter                                    | Hexagon Nut                                       |
| 47                   | 4                    | 07.2707               | Scheibe  | Disc  |
| 48                   | 1                    | 01.0264               | Zwischengehäuse P30/36-150D                        | Intermediate Casing P30/36-150D                   |
| 48                   | 1                    | 01.0265               | Zwischengehäuse P30/43-130D                        | Intermediate Casing P30/43-130D                   |
| o•49                 | 1                    | 06.0304               | O-Ring   | O-Ring  |
| o50                  | 6                    | 06.0927               | Manschette P30/36-150D                             | Sleeve P30/36-150D                                |
| •50                  | 6                    | 06.0949               | Manschette P30/43-130D                             | Sleeve P30/43-130D                                |
| o50A                 | 3                    | 06.0927               | Manschette P30/36-150D                             | Sleeve P30/36-150D                                |
| •50A                 | 3                    | 06.0949               | Manschette P30/43-130D                             | Sleeve P30/43-130D                                |
| 51                   | 3                    | 07.0959               | Stützring P30/36-150D                              | Support Ring P30/36-150D                          |
| 51                   | 3                    | 07.0960               | Stützring P30/43-130D                              | Support Ring P30/43-130D                          |
| o51A                 | 3                    | 06.0929               | O-Ring P30/36-150D                                 | O-Ring P30/36-150D                                |
| •51A                 | 3                    | 06.0956               | O-Ring P30/43-130D                                 | O-Ring P30/43-130D                                |
| 52                   | 1                    | 07.0705               | Stopfen G1/2                                       | Plug G1/2   |
| 53                   | 1                    | 07.1001               | Stopfen G3/4                                       | Plug G3/4   |
|                      |                      | 15.0927               | Ausziehwerkzeug f. Ventilsitz                      | Valve Seat Extractor                              |
|                      | 1                    | 00.4595               | Antrieb kpl. P30/36D (1-28/45-47)                  | Gear Assy P30/36D (1-28/45-47)                    |
|                      | 1                    | 00.4596               | Antrieb kpl. P30/43D (1-28/45-47)                  | Gear Assy P30/43D (1-28/45-47)                    |
|                      | 1                    | 00.3464               | Pumpenkopf kpl. P30/36-150D<br>(29-44/50/51/52/53) | Pump Head Assy P30/36-150D<br>(29-44/50/51/52/53) |
|                      | 1                    | 00.3467               | Pumpenkopf kpl. P30/43-130D<br>(29-44/50/51/52/53) | Pump Head Assy P30/43-130D<br>(29-44/50/51/52/53) |
| o                    | 1                    | 14.0360               | Rep. Satz Dichtungen P30/36-150D                   | Seal Repair Kit P30/36-150D                       |
| •                    | 1                    | 14.0361               | Rep. Satz Dichtungen P30/43-130D                   | Seal Repair Kit P30/43-130D                       |
| ••                   | 1                    | 14.0415               | Rep. Satz Ventile                                  | Valve Repair Kit                                  |

Bei Bestellung von Ersatzteilen bitte Bestell-Nr., Pumpen-Nr. und -type angeben  
When ordering please state Code No., Pump Model and Pump Serial No.

\* Bei Ersatzteilbestellung Pos. 29A mitbestellen.  
\* When ordering this part, Pos. 29A must also be ordered.

Technische Änderungen vorbehalten  
Subject to change

**P30 D**

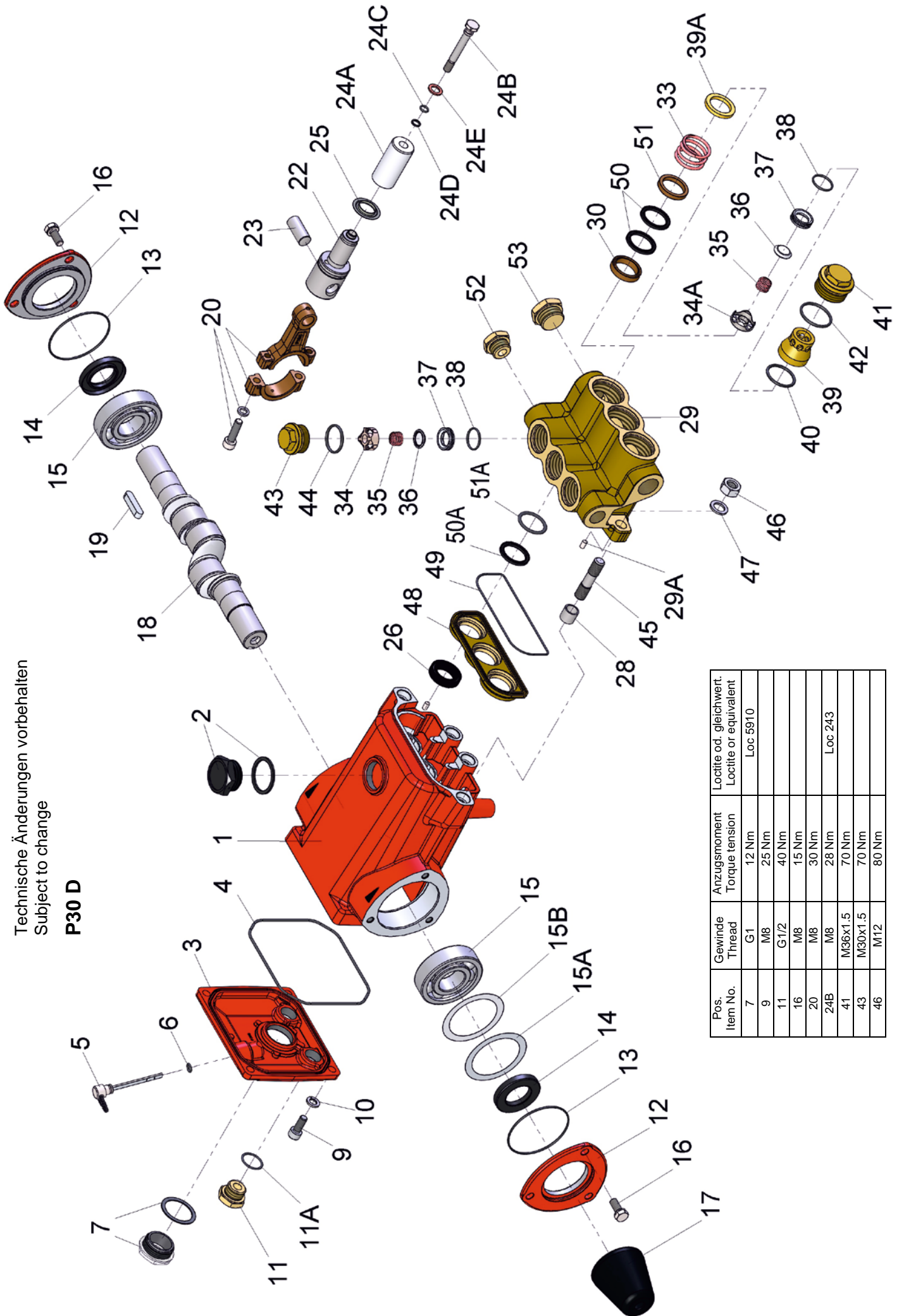

| Pos.<br>Item No. | Gewinde<br>Thread | Anzugsmoment<br>Torque tension | Loctite od. gleichwert.<br>Loctite or equivalent |
|------------------|-------------------|--------------------------------|--|
| 7                | G1                | 12 Nm                          | Loc 5910   |
| 9                | M8                | 25 Nm                          |  |
| 11               | G1/2              | 40 Nm                          |  |
| 16               | M8                | 15 Nm                          |  |
| 20               | M8                | 30 Nm                          |  |
| 24B              | M8                | 28 Nm                          |  |
| 41               | M36x1.5           | 70 Nm                          | Loc 243  |
| 43               | M30x1.5           | 70 Nm                          |  |
| 46               | M12               | 80 Nm                          |  |