

CSF



panel storage system

www.barbaric.at

barbaric
relieve with system.



The machine is designed as modular construction, the storage can be enlarged up to any size, depending on requirement and possibility of installation in production hall.

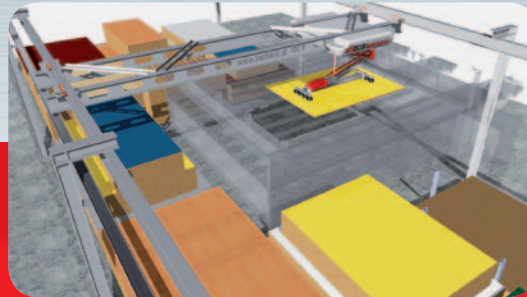

The storage areas are either chaotic or sorted. A mixed storage is also possible, the layout of the storage can be arranged new at any time.



The stacked panels can be requested either at the saw or at the "storage-PC". The windows based software is clearly arranged and easy to handle.

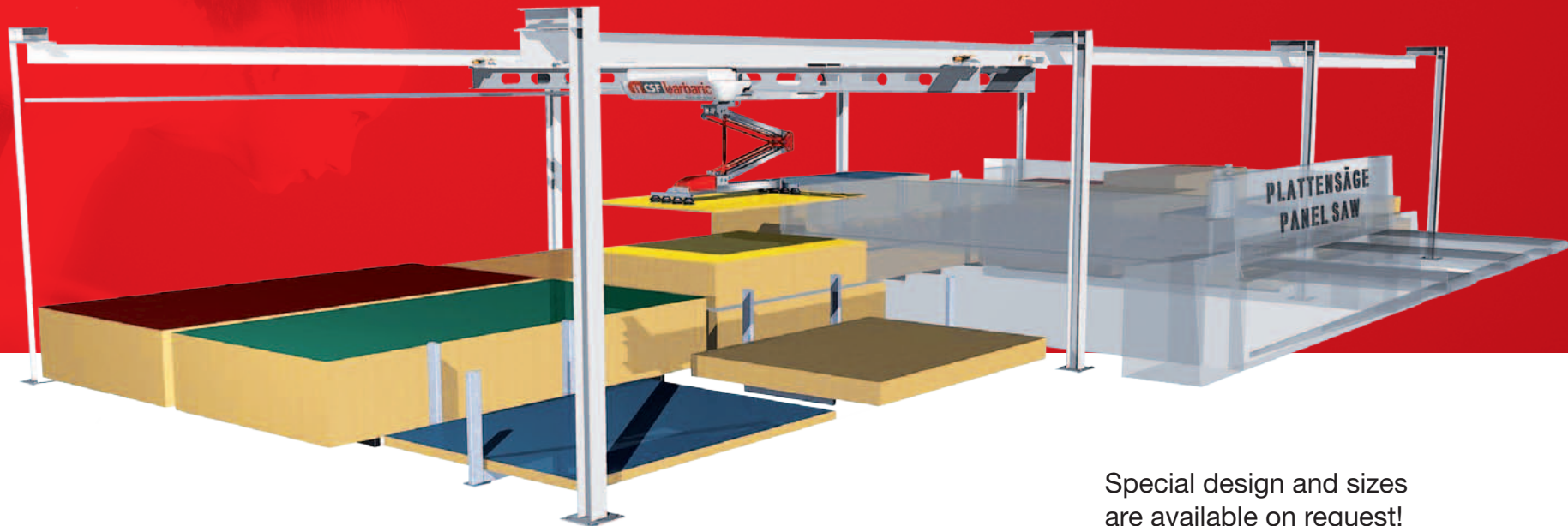

Special design and sizes are available on request!

CSF

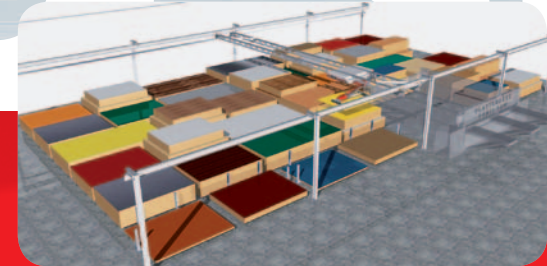
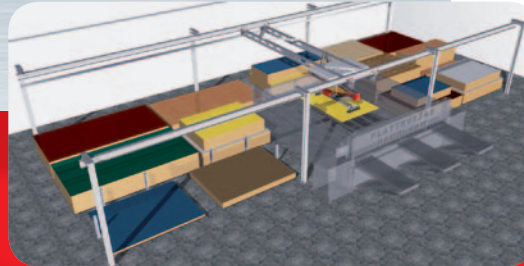
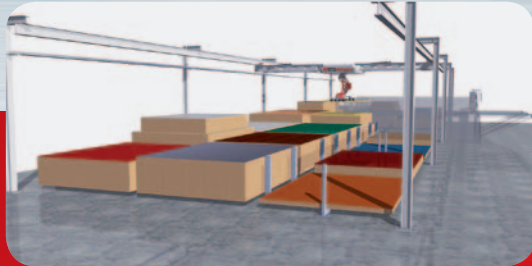

Automatic panel storage system CSF

Load: max. 200 kg
Panel size: max. 5600 x 2100 mm
Clock cycle: from 15 sec. possible
Stack height: 1800 mm
Operating voltage: 400 V 500 Hz

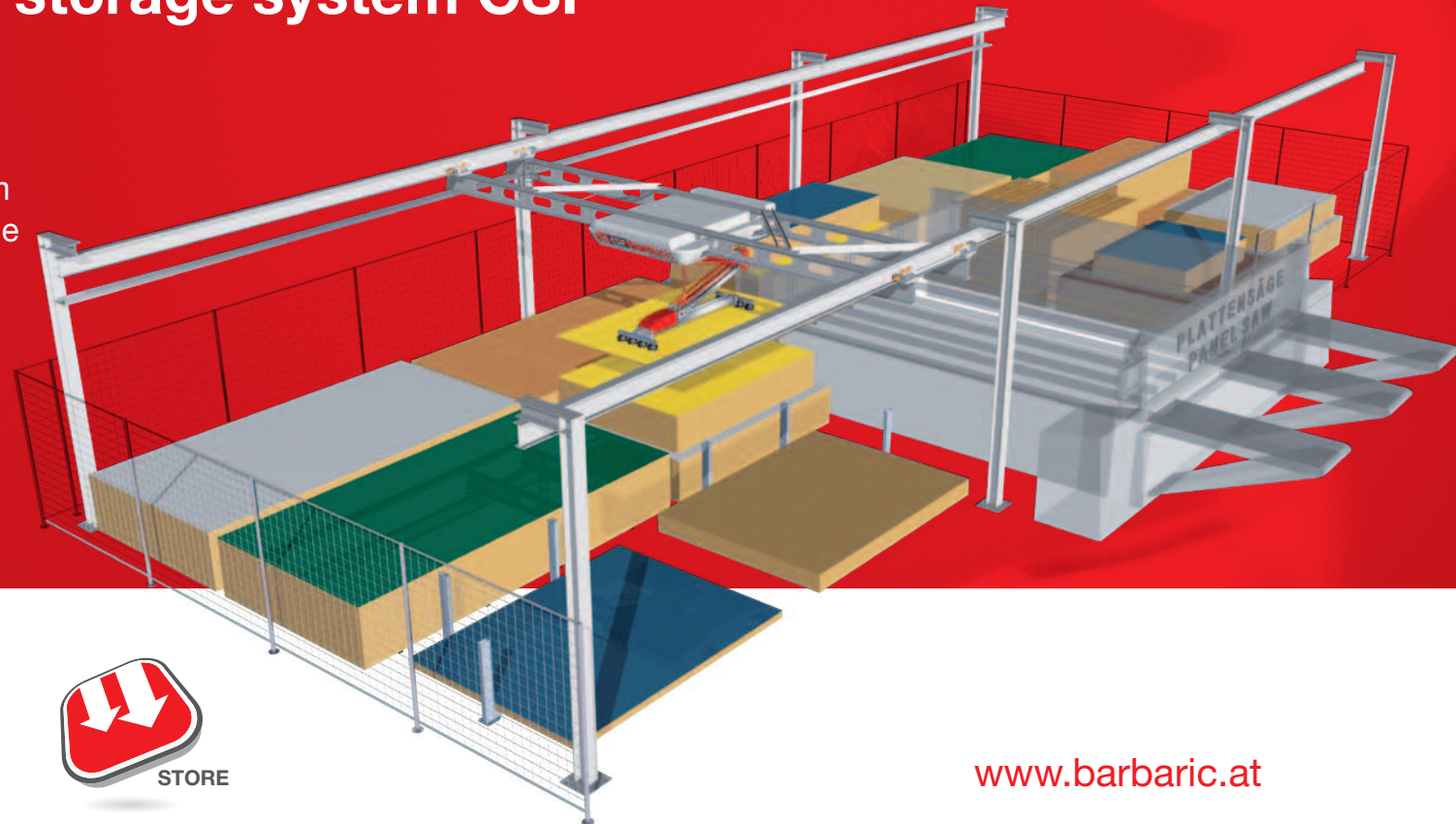

FEED



ADMINISTRATE



STORE

www.barbaric.at

- 
- >> up to date **drive and control technology**
 - >> enormous **potential in saving** space and staff costs
 - >> considerable **simplification** of working process
 - >> optimized **driving speed**
 - >> weight-optimized **construction**
 - >> improved **communication** between storage system and panel saw
 - >> innovative **design**
 - >> development and realization in close **collaboration** with the customer

panel storage CSF system

Barbaric GmbH, Pummererstraße 12, A-4020 Linz, Tel. +43 732 779 800
Fax +43 732 779 800-DW 10, Mail: sales@barbaric.at, www.barbaric.at

barbaric
relieve with system.