

## GRANLUND THREE-FLUTES COUNTERSINK 90° WITH CYLINDRICAL SHANK - A6108

DIN 335 C HSS

Model 200T  
 Material HSS  
 Standard DIN 335C  
 Countersinking Angle 90°  
 Surface treatment Bright  
 Cut Right-hand  
 Application 90° countersinking on all materials

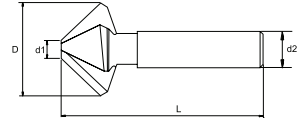

< 500	< 850	< 1200	< 600	< 850	DUPLEX	< 240	< 300	< 10% Si	> 10% Si	Brass Copper	Ti6Al4V	HTA	< 45	< 60	< 65
●	●	○	●	○		●	●	●							

DIN 335 C

Tech. Code	A04 Euro	D mm	L mm	d1 mm	d2 mm
A610810,4	21,50	10,4	47	2	6
A610812,4	22,50	12,4	48		
A610816,5	27,70	16,5	55	3	10

Tech. Code	A04 Euro	D mm	L mm	d1 mm	d2 mm
A610820,5	35,20	20,5	58	4	10
A610825	48,10	25	61		
A610830	76,10	30	65		

## GRANLUND THREE-FLUTES COUNTERSINKS 90° KIT - A6109

NEW

DIN 335 C HSS

Model 200T  
 Material HSS  
 Standard DIN 335C  
 Counterbore angle 90°  
 Surface treatment Bright  
 Cut Right



Tech. Code	A04 Euro	Description
A6109SET	215,20	5 countersinks kit 200T Granlund Ø 10,4 - 16,5 - 20,5 - 25 - 30

## CLtec THREE-FLUTES COUNTERSINK 90° WITH CYLINDRICAL SHANK - A6110

+ COD

DIN 335 C HSS

Material HSS  
 Standard DIN 335C  
 Angle 90°  
 Surface treatment Bright  
 Cut Right-hand  
 Application 90° countersinking on all materials

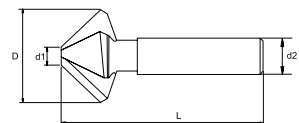

< 500	< 850	< 1200	< 600	< 850	DUPLEX	< 240	< 300	< 10% Si	> 10% Si	Brass Copper	Ti6Al4V	HTA	< 45	< 60	< 65
●	●	○	●	○		●	●	●							

DIN 335 C

Tech. Code	A04 Euro	D mm	L mm	d1 mm	d2 mm
A61105	11,20	5	40	1.5	4
A61106	11,20	6	45		5
A61106,3	11,20	6,3	50	2	6
A61108	12,20	8			
A61108,3	13,00	8,30	50	2.5	6
A611010	14,60	10			
A611010,4	10,80	10,40	56	2.5	8
A611012,4	15,10	12,4			

Tech. Code	A04 Euro	D mm	L mm	d1 mm	d2 mm
A611015	16,30	15	60	3.2	10
A611016,5	17,70	16,5		3.5	
A611020,5	25,30	20,5	63	3.5	12
A611025	32,90	25	67	3.8	
A611028	46,10	28,00	71	4,2	12
A611030	49,00	30		4,2	
A611031	55,30	31,00		4,2	



## LTec STRAIGHT SHANK COUNTERSINKS SET - A6125

**DIN 335 C** **HSS**

**Material** HSS  
**Standard** DIN 335C  
**Counterbore angle** 90°  
**Surface treatment** Bright - TIN (coated)  
**Cut** Right-hand  
**Application** 90° countersinking on all materials



Tech. Code	A04 Euro	Description
A6125SETA6110	108,70	Set of 5 countersink 90° Ø 8 - 12.4 - 16.5 - 20.5 - 25
A6125SETA6115	179,70	Set of 5 countersink 90° TIN Ø 8 - 12.4 - 16.5 - 20.5 - 25

## GRANLUND THREE-FLUTES COUNTERSINK 90° WITH CYLINDRICAL SHANK - A6111

**DIN 335 C** **HSS**

**Model** 100T  
**Material** HSS  
**Standard** DIN 335C  
**Countersinking Angle** 90°  
**Surface treatment** Bright  
**Cut** Right-hand  
**Application** 90° countersinking on all materials

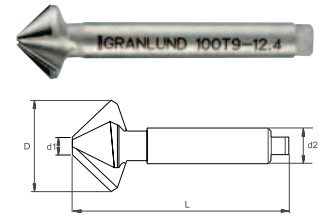

(\*) Cylindrical shank with 3 facets

< 500	< 850	< 1200	< 600	< 850	DUPLEX	< 240	< 300	< 10% Si	> 10% Si	Brass Copper	Ti6Al4V	HTA	< 45	< 60	< 65
●	●	○	●	○		●	●	●							

DIN 335 C

Tech. Code	A04 Euro	D mm	L mm	d1 mm	d2 mm	Tech. Code	A04 Euro	D mm	L mm	d1 mm	d2 mm		
A611104,3	22,10	4,3	44	1,5	6	A611116	39,50	16	55	3,0	10 (*)		
A611105	21,80	5				A611116,4	39,50	16,4					
A611106	22,20	6				A611116,5	39,50	16,5					
A611106,3	22,20	6,3				A611118	50,60	18					
A611106,5	23,40	6,5	44,5	A611119	53,30	19	A611120	53,60	20	57			
A611107	23,40	7	45	A611120,5	53,60	20,5	57,5	A611122	69,90	22		58,5	
A611107,3	24,30	7,3		A611123	69,90	23	59	A611125	72,00	25		60,5	
A611108,0	24,30	8	45,5	2,0	A611126	97,50	26	61	A611128	100,10		28	62,5
A611108,3	25,00	8,3			A611130	109,60	30	64	A611134	137,70		34	74
A611108,6	26,40	8,6	46	A611131	110,90	31	64,5	A611135	142,80	35		75	
A611109,4	27,30	9,4		A611137	154,40	37	76	A611140	170,50	40		77	
A611110	28,90	10	46,5	A611135	142,80	35	75						
A611110,4	30,00	10,4		A611137	154,40	37	76						
A611111,5	31,90	11,5	47,5	A611137	154,40	37	76						
A611112	32,30	12		A611140	170,50	40	77						
A611112,4	32,30	12,4	48										
A611113,4	34,00	13,4		48,5									
A611115	36,50	15	54	3,0	10 (*)								

## GRANLUND THREE FLUTES SINKS 90° KIT - A6113

NEW

DIN 335 C HSS

Model 100T  
Material HSS  
Standard DIN 335C  
Angolo di svasatura 90°  
Surface treatment Bright  
Cutting Right-hand

Tech. Code	A04 Euro	
A6113SET	290,30	5 countersinks kit 100T Granlund Ø 10 - 16 - 20 - 25 - 30



## GRANLUND THREE FLUTES EXTERNAL SINKS 90° KIT - A6114

NEW

DIN 335 C HSS

Model 100T  
Material HSS  
Norma DIN 335C  
Angolo di svasatura 90°  
Surface treatment Bright  
Cutting Right-hand

Tech. Code	A04 Euro	
A6114SET	264,70	7 countersinks kit 100T Granlund Ø 6,3 - 8,3 - 10,4 - 12,4 - 16,5 - 20,5 - 25



## CLtec THREE-FLUTES CARBIDE COUNTERSINK 90° - A6112

NdF HM

Material Carbide micro-grain  
Standard Factory Standard  
Countersink angle 90°  
Cutting Right-hand  
Surface treatment Bright  
Application 90° countersinking on all materials

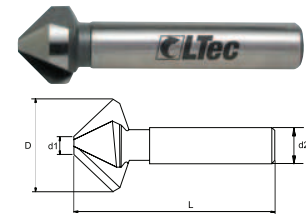

< 500	< 850	< 1200	< 600	< 850	DUPLEX	< 240	< 300	< 10% Si	> 10% Si	Brass Copper	T6AlV	HTA	< 45	< 60	< 65
●	●	○	●	○	○	●	●	●	○	○	○	○	●	○	○

### FACTORY STANDARD

Tech. Code	A04 Euro	D mm	L mm	d1 mm	d2 mm	Tech. Code	A04 Euro	D mm	L mm	d1 mm	d2 mm
A61126,3906	32,10	6.3	51	1,5	6	A611216,59010	45,70	16.5	58	3,2	10
A61128,3906	29,00	8.3	52	2		A611220,5906	63,80	20.5	61	3,5	6
A611210,4906	32,60	10.4	53	2,5		A611220,5908	63,80				8
A611212,4906	35,40	12.4	55	2,9		A611220,59010	63,80				10
A611212,4908	35,40					A611225,59010	100,30	25.5	64	3,8	
A611216,5906	45,70	16.5	58	3,2		A611231,59010	137,30	31.5	68	4,2	10
A611216,5908	45,70				8						

## CLtec THREE-FLUTES COUNTERSINK 90° WITH CYLINDRICAL SHANK - A6115

DIN 335 C HSS TiN

Material HSS  
Standard DIN 335C  
Angle 90°  
Surface treatment TiN (coated)  
Cut Right-hand  
Application 90° countersinking on hard materials and special alloys

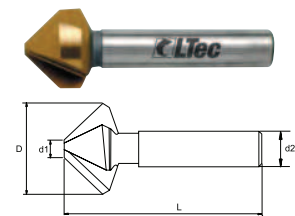

< 500	< 850	< 1200	< 600	< 850	DUPLEX	< 240	< 300	< 10% Si	> 10% Si	Brass Copper	T6AlV	HTA	< 45	< 60	< 65
●	●	○	●	○	○	●	●	●	○	○	○	○	●	○	○

### DIN 335 C

Tech. Code	A04 Euro	D mm	L mm	d1 mm	d2 mm	Tech. Code	A04 Euro	D mm	L mm	d1 mm	d2 mm
A61155	21,00	5	40	1.5	4	A611515	38,50	15	60	3.2	10
A61156	21,90	6	45		5	A611516,5	39,90	16.5			
A61156,3	21,90	6.3	50		2	A611520,5	58,70	20.5	63	3.5	
A61158	23,70	8				A611525	74,80	25	67	3.8	
A611510	29,90	10				A611530	101,70	30	71	4.2	
A611512,4	32,30	12.4	56		2.9	8					

Indivisible package

Suggested retail package - Unit price



## LTec THREE-FLUTES COUNTERSINK 90° WITH MORSE TAPER SHANK - A6120

**DIN 335 D** **HSS**

**Material** HSS  
**Standard** DIN 335D  
**Angle** 90°  
**Surface treatment** Bright  
**Cut** Right-hand  
**Application** 90° countersinking on all materials

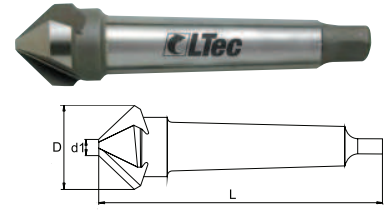

< 500	< 850	< 1200	< 600	< 850	DUPLEX	< 240	< 300	< 10% Si	> 10% Si	Brass Copper	Ti6Al4V	HTA	< 45	< 60	< 65
●	●	○	●	○		●	●	●							

### DIN 335 D

Tech. Code	A04 Euro	D mm	L mm	d1 mm	CM	Tech. Code	A04 Euro	D mm	L mm	d1 mm	CM
A612025	67,10	25	106	3.8	2	A612040	83,50	40	140	10	3
A612031	78,10	31	112	4.2		A612050	104,40	50	150	14	

## GRANLUND THREE-FLUTES TIN COATED COUNTERSINK 90° WITH CYLINDRICAL SHANK - A6140

**DIN 335 C** **HSS** **TiN**

**Model** 100TT  
**Material** HSS  
**Standard** DIN 335C  
**Countersinking Angle** 90°  
**Surface treatment** Tin (coated)  
**Cut** Right-hand  
**Application** 90° countersinking on hard materials and special alloys

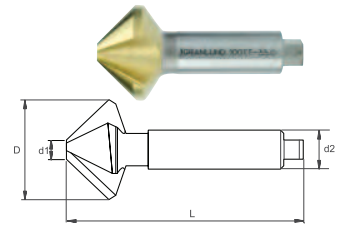

(\*) Cylindrical shank with 3 facets

< 500	< 850	< 1200	< 600	< 850	DUPLEX	< 240	< 300	< 10% Si	> 10% Si	Brass Copper	Ti6Al4V	HTA	< 45	< 60	< 65
●	●	○	●	○		●	●	●							

### DIN 335 C COUNTERSINK

Tech. Code	A04 Euro	D mm	L mm	d1 mm	d2 mm	Tech. Code	A04 Euro	D mm	L mm	d1 mm	d2 mm
A614006	26,90	6,0	44,0	1,5	6	A614016	47,50	16,0	55,0	3,0	10 (*)
A614006,3	26,90	6,3				A614016,5	47,50	16,5			
A614008	29,20	8,0				A614020	64,60	20,0	57,0		
A614008,3	30,10	8,3	A614020,5	64,60		20,5	57,5				
A614010	35,20	10,0	46,0	A614025		86,40	25,0	60,5			
A614010,4	36,10	10,4	46,5	A614030		131,80	30,0	64,0			
A614012	38,40	12,0	47,5	2,0	A614035	171,90	35,0	75,0	8,0	16	
A614012,4	38,40	12,4	48,0	3,0	A614040	204,40	40,0	77,0			
A614015	44,10	15,0	54,0	3,0							

## GRANLUND THREE-FLUTES TIN COATED COUNTERSINK 60° WITH CYLINDRICAL SHANK - A6145

**DIN 334 C** **HSS** **TiN**

**Model** 100TT  
**Material** HSS  
**Standard** DIN 334C  
**Countersinking Angle** 60°  
**Surface treatment** Tin (coated)  
**Cut** Right-hand  
**Application** 60° countersinking on hard materials and special alloys

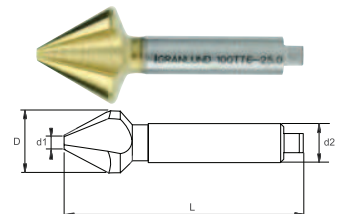

(\*) Cylindrical shank with 3 facets

< 500	< 850	< 1200	< 600	< 850	DUPLEX	< 240	< 300	< 10% Si	> 10% Si	Brass Copper	Ti6Al4V	HTA	< 45	< 60	< 65
●	●	○	●	○		●	●	●							

### DIN 334 C COUNTERSINK

Tech. Code	A04 Euro	D mm	L mm	d1 mm	d2 mm	Tech. Code	A04 Euro	D mm	L mm	d1 mm	d2 mm
A614510	38,40	10	49	2	6	A614520	68,50	20	63	4	10 (*)
A614512	38,40	12	51,5			A614525	93,60	25	68		
A614516	49,10	16	59,5	3	10 (*)	A614530	147,70	30	73,5		

## GRANLUND THREE-FLUTES COUNTERSINK 60° WITH CYLINDRICAL SHANK - A6150

**DIN 334 C** **HSS**

**Model** 100T  
**Material** HSS  
**Standard** DIN 334C  
**Countersinking Angle** 60°  
**Surface treatment** Bright  
**Cut** Right-hand  
**Application** 60° countersinking on all materials

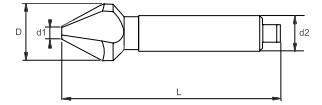

(\*) Cylindrical shank with 3 facets

< 500	< 850	< 1200	< 600	< 850	DUPLEX	< 240	< 300	< 10% Si	> 10% Si	Brass Copper	Ti6Al4V	HTA	< 45	< 60	< 65
●	●	○	●	○		●	●	●							

### DIN 334 C COUNTERSINK

Tech. Code	A04 Euro	D mm	L mm	d1 mm	d2 mm	Tech. Code	A04 Euro	D mm	L mm	d1 mm	d2 mm
A615008	24,60	8	47,5	1,5	6	A615020	59,70	20	63,0	4,0	10 (*)
A615010	32,30	10	49,0	2,0		A615025	78,00	25	68,0		
A615012	32,30	12	51,5	3,0		A615030	129,30	30	73,5		
A615016	40,90	16	59,5	4,0		A615040	183,40	40	88,0		

## GRANLUND THREE-FLUTES COUNTERSINK 90° WITH LONG CYLINDRICAL SHANK - A6153

**NdF** **HSS**

**Model** 100TL  
**Material** HSS  
**Standard** NDF  
**Countersinking Angle** 90°  
**Surface treatment** Bright  
**Cut** Right-hand  
**Application** 90° countersinking

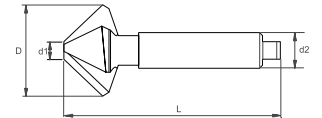

(\*) Cylindrical shank with 3 facets

< 500	< 850	< 1200	< 600	< 850	DUPLEX	< 240	< 300	< 10% Si	> 10% Si	Brass Copper	Ti6Al4V	HTA	< 45	< 60	< 65
●	●	○	●	○		●	●	●							

### COUNTERSINK NDF

Tech. Code	A04 Euro	D mm	L mm	d1 mm	d2 mm	Tech. Code	A04 Euro	D mm	L mm	d1 mm	d2 mm
A615312	47,90	12	112,0	4	10 (*)	A615325	107,90	25	121,5	4	10 (*)
A615316	68,50	16	116,0			A615330	164,70	30	125,0		
A615320	80,90	20	118,0								

## GRANLUND THREE-FLUTES CARBIDE TIPPED COUNTERSINK 90° CYLINDRICAL SHANK - A6155

**DIN 335 C** **HSS + HM**

**Model** 100TH  
**Material** HSS + HM K10  
**Standard** DIN 335 C  
**Countersinking Angle** 90°  
**Cut** Right-hand  
**Application** 90° countersinking

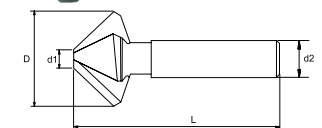

(\*) Cylindrical shank with 3 facets

< 500	< 850	< 1200	< 600	< 850	DUPLEX	< 240	< 300	< 10% Si	> 10% Si	Brass Copper	Ti6Al4V	HTA	< 45	< 60	< 65
●	●	○	●	○		●	●	●	○	○	○		●	○	

### DIN 335 C COUNTERSINK

Tech. Code	A04 Euro	D mm	L mm	d1 mm	d2 mm	Tech. Code	A04 Euro	D mm	L mm	d1 mm	d2 mm		
A615512	194,60	12	49,0	4	6	A615525	215,40	25	36,0	4	10 (*)		
A615516	199,10	16	57,2		10 (*)	A615530	242,00	30	67,0				
A615520	207,20	20	60,0			A615540	293,20	40	79,0			8	16



## CLTec THREE-FLUTES EXTERNAL COUNTERSINKS 90° WITH CYLINDRICAL SHANK - A6160

**NEW**

**NdF** **HSS**

**Material** HSS  
**Norma** NDF  
**Countersinking angle** 90°  
**Cut** Right  
**Application** 90° external countersinking on all materials

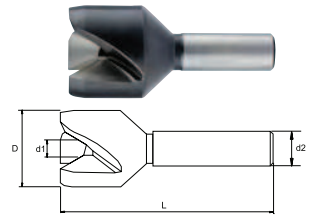

< 500	< 850	< 1200	< 600	< 850	DUPLEX	< 240	< 300	< 10% Si	> 10% Si	Brass Copper	Ti6Al4V	HTA	< 45	< 60	< 65
●	●	○	●	○		●	●	●	●	●					

NDF

Tech. Code	A04 Euro	D mm	L mm	d1 mm	d2 mm
A61600412	26,80	12	55	4	8
A61600620	46,40	20	60	6	10

Tech. Code	A04 Euro	D mm	L mm	d1 mm	d2 mm
A61600828	69,60	28	65	8	14

## CLTec 90° COUNTERBORES FOR CYLINDRICAL HEAD SCREWS WITH STRAIGHT SHANK - A6230

**NEW**

**HSSE** **DIN 1866**

**Material** HSSE  
**Standard** DIN 1866  
**Surface treatment** Bright  
**Cut** Right-hand 4 flutes  
**Application** Counterboring for cylindrical head screws

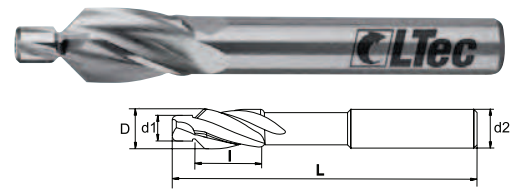

< 500	< 850	< 1200	< 600	< 850	DUPLEX	< 240	< 300	< 10% Si	> 10% Si	Brass Copper	Ti6Al4V	HTA	< 45	< 60	
●	●	○	●	○		●	●	●	●	●					

DIN 1866

Tech. Code	A04 Euro	Screw mm	L mm	l mm	D mm	d1 mm	d2 mm
A6230M3	26,80	M3	71	14	6,5	3,2	6
A6230M4	26,80	M4			8,6	4,3	8
A6230M5	37,60	M5	80	18	10,6	5,3	10

Tech. Code	A04 Euro	Screw mm	L mm	l mm	D mm	d1 mm	d2 mm
A6230M6	39,90	M6	80	18	12,6	6,4	10
A6230M8	57,70	M8			16,7	8,4	12
A6230M10	61,70	M10	100	22	20,7	10,5	

## CLTec 180° COUNTERBORES FOR CYLINDRICAL HEAD SCREWS WITH STRAIGHT SHANK - A6210

**DIN 373** **HSSE**

**Material** HSSE  
**Standard** DIN 373  
**Surface treatment** Bright  
**Cut** Right-hand 3 flutes  
**Application** Counterboring for cylindrical head screws

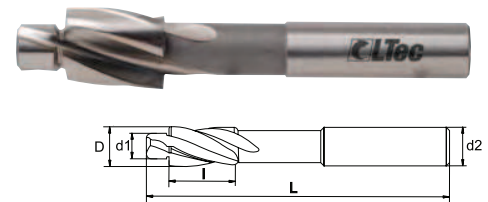

< 500	< 850	< 1200	< 600	< 850	DUPLEX	< 240	< 300	< 10% Si	> 10% Si	Brass Copper	Ti6Al4V	HTA	< 45	< 60	< 65
●	●	○	●	○		●	●	●	●	●					

DIN 373

Tech. Code	A04 Euro	Screw mm	L total mm	l1 mm	D mm	d mm	d2 mm	Z
A6210M3	20,00	M3	71	14	6	3.2	5	3
A6210M4	20,00	M4			8	4.3		
A6210M5	20,00	M5			10	5.3		
A6210M6	20,80	M6	80	18	11	6.4	8	
A6210M8	29,50	M8			15	8.4		
A6210M10	36,90	M10			18	10.5		
A6210M12	47,80	M12	100	22	20	13	12	
A6210M14	65,60	M14			24	15		
A6210M16	82,80	M16			30	17		

## LTec 180° COUNTERBORES FOR CYLINDRICAL HEAD SCREWS WITH STRAIGHT SHANK - A6216

NEW

DIN 373 HSSE

Material HSSE  
 Standard DIN 373  
 Surface treatment Bright  
 Cut Right-hand 4 flutes  
 Application Counterboring for cylindrical head screws

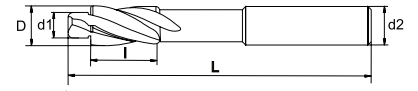

< 500	< 850	< 1200	< 600	< 850	DUPLEX	< 240	< 300	< 10% Si	> 10% Si	Brass Copper	Ti6Al4V	HTA	< 45	< 60	< 65
●	●	○	●	○		●	●	●							

### DIN 373

Tech. Code	A04 Euro	Screw mm	L total mm	l mm	D mm	d1 mm	d2 mm	Z
A6216M3	22,00	M3	71	14	6,0	3,2	5	4
A6216M4	25,60	M4			7,4	4,3		
A6216M5	30,10	M5	80	18	9,4	5,3	8	
A6216M6	30,10	M6			10,4	6,4		
A6216M8	36,20	M8	100	22	13,5	8,4	12	
A6216M10	45,30	M10			16,5	10,5		
A6216M12	54,00	M12			20,0	13,0		
A6216M14	65,60	M14	130	30	24,0	15,0	16	
A6216M16	82,80	M16	150		26,0	17,0	20	

## LTec 180° COUNTERBORES SET - A6218

NEW

DIN 373 HSSE

Material HSS  
 Standard DIN 373  
 Counterbore angle 180°  
 Surface treatment Bright - TIN (coated)  
 Cut Right-hand  
 Application 180° counterboring on all materials



Tech. Code	A04 Euro	Description
A6218Z3	147,00	Set of 6 counterborers for Z3 cylindrical head screws Tech. Code A6210 from M3 to M10
A6218Z4	189,00	Set of 6 counterborers for Z4 cylindrical head screws Tech. Code A6216 from M3 to M10





## EZBURR FRONT AND BACK DEBURRING TOOLS - A6310

EZ BURR tool allows for front and back deburring in a single pass.

Tech. Code	A04 Euro	D mm	D1 Offset mm	L1 mm	L2 mm	L3 mm	L mm	D mm	Application mm	Blade Cod.	
A6310L1A2,5	237,60	2,5	-0,10 ± -0,12	11	31,7	25	85,6	6	2,47 ÷ 2,65	L1A	1
A6310L1A3	237,60	3,0							2,97 ÷ 3,15		
A6310L1B3,3	237,60	3,3							3,27 ÷ 3,45		
A6310L2A4	213,20	4,0	-0,15 ± -0,20	13	44	33	114	3,90 ÷ 4,40	L2A		
A6310L2B5	213,20	5,0						4,90 ÷ 5,40			
A6310L2B6	213,20	6,0						5,90 ÷ 6,40			
A6310L3A8	217,30	8,0	-0,17 ± -0,25	17	-	-	127	7,90 ÷ 8,40	L3A		
A6310L3A8,5	217,30	8,5						8,40 ÷ 8,90			
A6310L3B10	231,50	10,0						9,90 ÷ 11,0			
A6310L3B12	244,70	12,0	-	114	-	-	165	11,90 ÷ 13,00	L3B		
A6310L3B14	286,30	14,0						13,90 ÷ 15,00			
A6310L3B16	322,80	16,0						15,90 ÷ 17,00			



## EZBURR STANDARD BLADES FOR DEBURRING TOOLS TYPE B - A6320

Tech. Code	A04 Euro	Tool Dimension	Front cutting angle	Back cutting angle	
A6320L1A	43,70	L1A	45°	60°	1
A6320L1B	43,70	L1B			
A6320L2A	43,70	L2A			
A6320L2B	43,70	L2B			
A6320L3A	43,70	L3A			
A6320L3B	43,70	L3B			

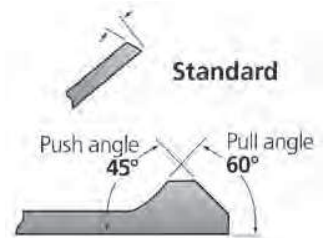

## EZBURR POSITIVE BLADES FOR DEBURRING TOOLS TYPE B - A6321

Tech. Code	A04 Euro	Tool Dimension	Front cutting angle	Back cutting angle	
A6321L1A	43,70	L1A	45°	60°	1
A6321L1B	43,70	L1B			
A6321L2A	43,70	L2A			
A6321L2B	43,70	L2B			
A6321L3A	43,70	L3A			
A6321L3B	43,70	L3B			

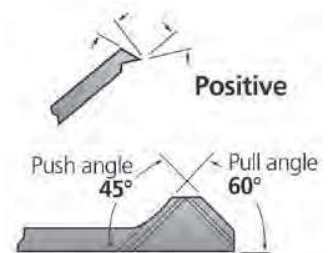

### TOOLS FOR FRONT AND REAR BURR REMOVAL

EZ Burr tools are manufactured for front and rear burr removal.

No other HSS deburring tool are designed whit the flexible blade to operate independent from springs and plungers, A solid shank particularly strong assure a great durability.

The patented E-Z Burr HSS deburring tool allows you to change chamfer settings, and cutting blades without removing it from the holder.

Once the desired chamfer is set, it won't change, even from blade to blade. The result is less downtime, more production.

