



# 10" KPAK<sup>®</sup> PLUS Module

High Productivity Zero Bypass Ultrafiltration Spiral Module for Electrocoat Paint

## PRODUCT DESCRIPTION

<b>Membrane Chemistry:</b>	PVDF
<b>Membrane Type:</b>	HFM-183 (Positive Charge)
<b>Construction:</b>	Spiral wound element with integrated PVC housing
<b>Seal:</b>	EPDM

## NOMINAL SPECIFICATIONS

Part Number	Model	Feed Spacer mil (mm)	Membrane Area ft <sup>2</sup> (m <sup>2</sup> )
0750790	KPAK PLUS 10738-M183-LPP	30 (0.8)	512 (47.6)

## OPERATING AND DESIGN INFORMATION\*

<b>Maximum Inlet Pressure at Temperature:</b>	80.0 psi @ 100° F (5.5 bar @ 37 °C)
<b>Maximum Inlet Pressure at Temperature:</b>	56.0 psi @ 120° F (3.9 bar @ 49 °C)
<b>Maximum Operating Temperature at Pressure:</b>	125° F @ 49 psi (51.6 °C @ 3.4 bar)
<b>Minimum Outlet Pressure:</b>	10.0 psi (0.70 bar)
<b>Maximum Permeate Side Back Pressure:</b>	5.0 psi (0.34 bar)
<b>Maximum Feed Side Pressure Drop:</b>	35.0 psi @ 125° F (2.4 bar @ 51.6° C)
<b>Allowable pH – Continuous Exposure:</b>	2.0 – 10.0 pH @ 125 °F (51.6 °C)
<b>Allowable pH – Short Term Exposure:</b>	1.5 – 10.5 pH @ 125 °F (51.6 °C)

\*Koch Separation Solutions, Inc. must review operating and cleaning conditions for all new plants and any changes to existing plants

## FEED FLOW VS. PRESSURE DROP (TYPICAL)\*

Circulation Flow		Pressure Drop	
gpm	m <sup>3</sup> /hr	psi	bar
97	21.6	25	1.7
109	24.3	30	2.1
117	26.1	35	2.4

\*Data are based on water @ 77°F and a specific gravity of 1.0. Circulation rates exhibit variances of + 15%.

## NOMINAL DIMENSIONS

<b>Element Length:</b>	38.0 in (965 mm)
<b>Element O.D.:</b>	10.75 in (273.1 mm)
<b>Permeate Tube I.D.:</b>	1.3 in (33.0 mm)
<b>Element Shipping Weight:</b>	95 lbs (43 kg)
<b>Element Working Weight:</b>	150 lbs (68.2 kg)



**OPERATING GUIDELINES**

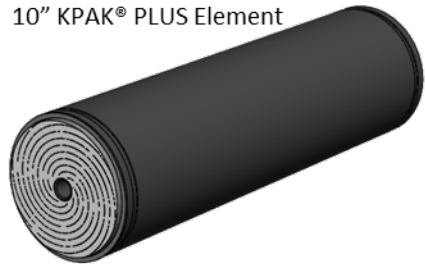
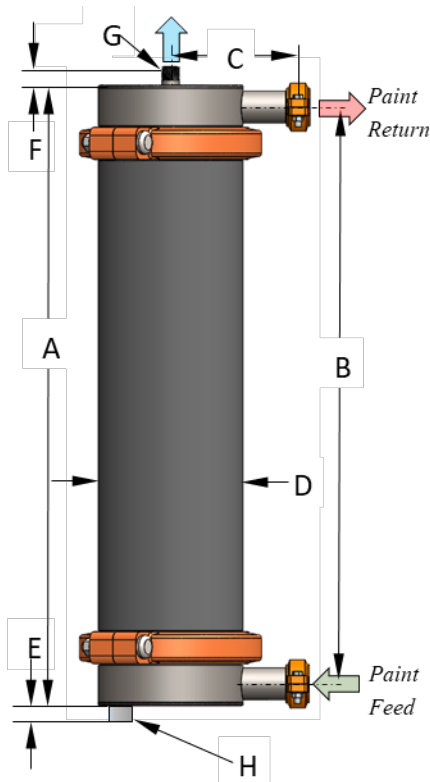

Replacement 10" Seal Kit (EPDM)  
 Metric 0235044  
 Imperial 2" Port 0235044



MODEL	A	B	C	D	E	F	G	H
Metric (mm)	1,167	1,086	241	273	28	28	1" MBSPTG	1/2" FBSP
Imperial (inch)	46	42 3/4	9 1/2	10 3/4	N/A	1 1/4	1" MNPT	N/A

10" Metric  
Systems Kit  
4001339

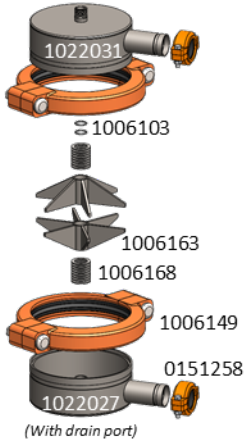

10" Imperial  
Systems Kit  
1005955

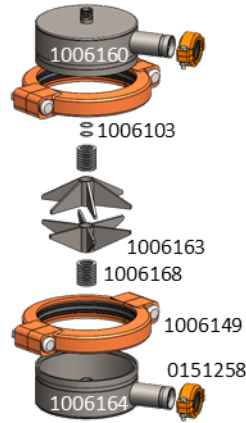

*The information contained in this publication is believed to be accurate and reliable, but is not to be construed as implying any warranty or guarantee of performance. We assume no responsibility, obligation or liability for results obtained or damages incurred through the application of the information contained herein. Refer to Standard Terms and Conditions of Sale and Performance Warranty documentation for additional information*

**Koch Separation Solutions, Inc.** 850 Main Street, Wilmington, MA 01887  
 Main: +1-978-694-7000 • Fax: +1-978-657-5208 • Toll Free: +1-888-677-5624

For complete contact information and listing of our global locations, visit [www.kochseparation.com](http://www.kochseparation.com)

©2020 Koch Separation Solutions, Inc. All rights reserved worldwide. For related trademark information, visit [www.kochseparation.com/legal](http://www.kochseparation.com/legal).