

SQUARE SOLID SURFACE (S1) - INSTALLATION DRAWING - FRONT AND SIDE VIEW

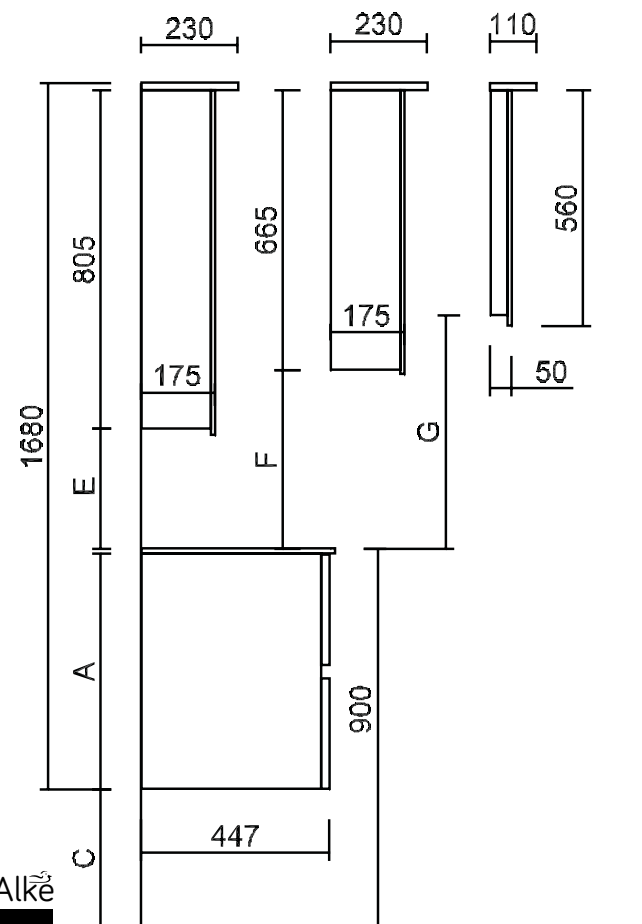
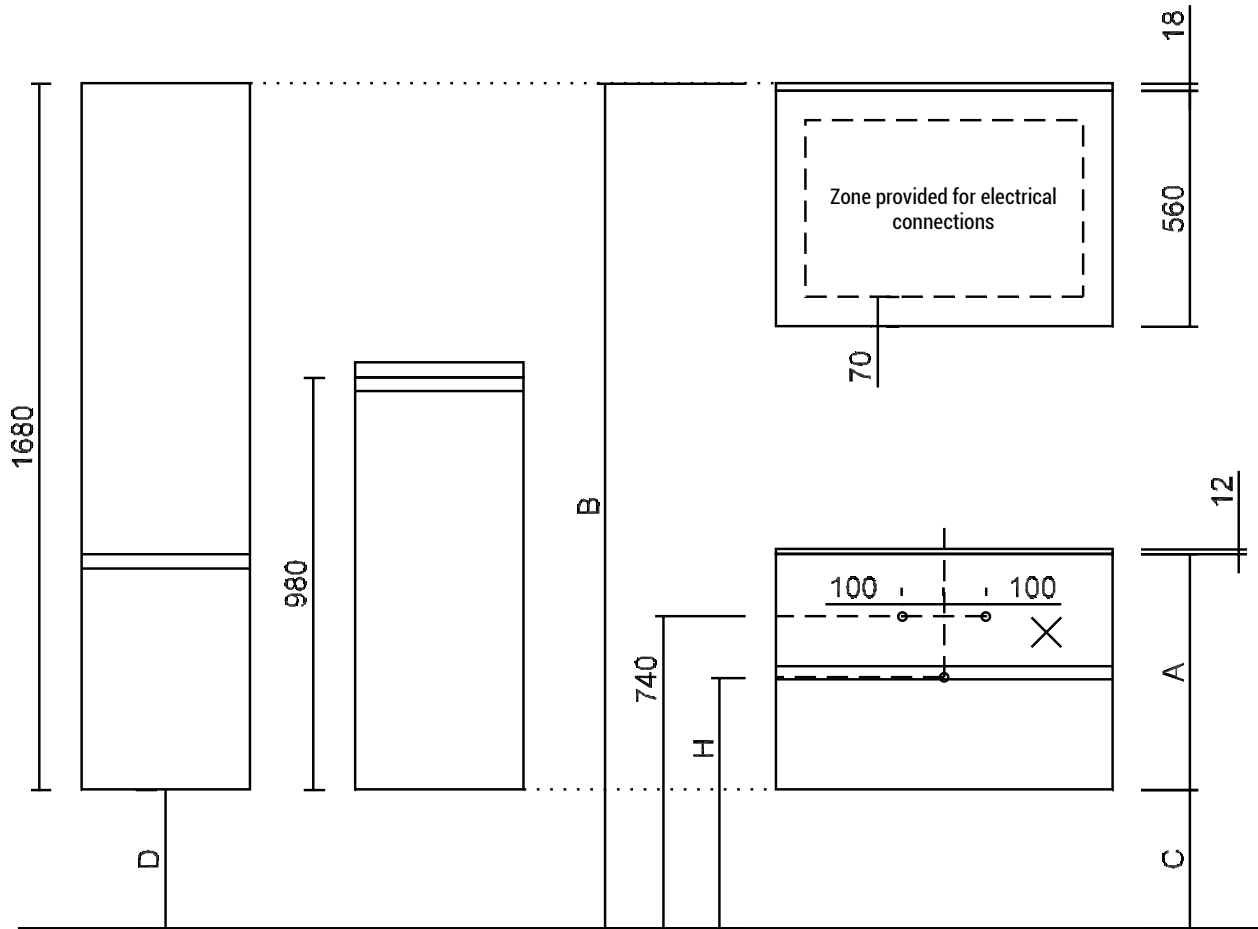

CAUTION! In the case of two washbasins, the water supply and drainage must be placed at the same height below the centre of each washbasin.

Top view washbasins solid surface - see p. 378

Solid surface (S1) - without overflow
thickness 15mm - depth 460mm

Type	A	B	C	D	E	F	G	H
Without grip	560	2008	328	328	285	425	555	655
Without grip	399	2008	489	328	285	425	555	710
Without grip	295	2008	593	328	285	425	555	710
Without grip	267	2008	621	328	285	425	555	710
FARM	532	2036	356	356	313	453	583	655
FARM	399	2036	489	356	313	453	583	710
FARM	267	2036	621	356	313	453	583	710

Without LED canopy, the distance E, F and G will be 18mm greater.

Solid surface (S1) - with overflow
type XXAK177 thickness 15mm - depth 460mm

Type	A	B	C	D	E	F	G	H
Without grip	560	2008	328	328	285	425	555	595
Without grip	399	2008	489	328	285	425	555	650
Without grip	295	2008	593	328	285	425	555	650
Without grip	267	2008	621	328	285	425	555	650
FARM	532	2036	356	356	313	453	583	595
FARM	399	2036	489	356	313	453	583	650
FARM	267	2036	621	356	313	453	583	650

Without LED canopy, the distance E, F and G will be 18mm greater.

SQUARE SOLID SURFACE (S2) - INSTALLATION DRAWING - FRONT AND SIDE VIEW

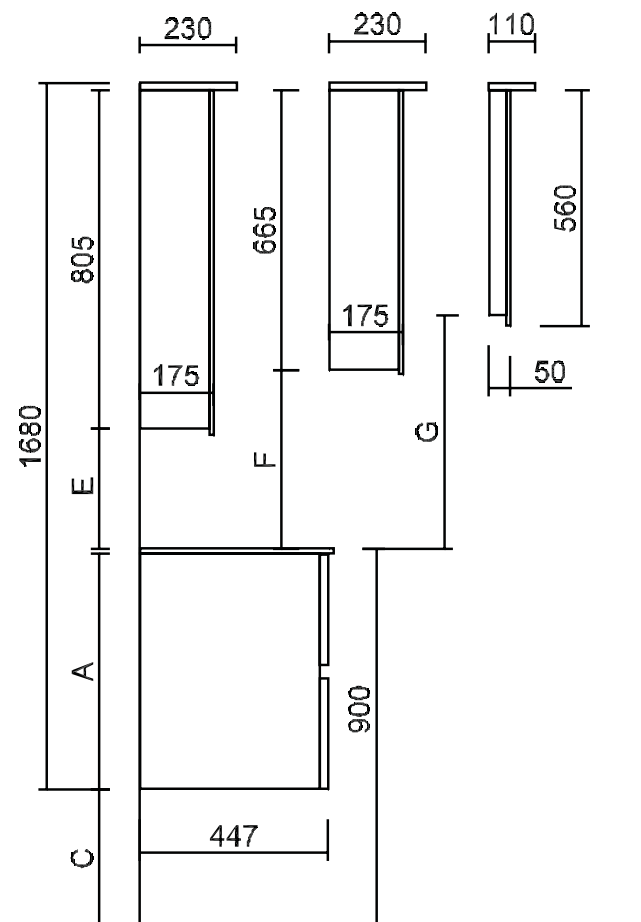
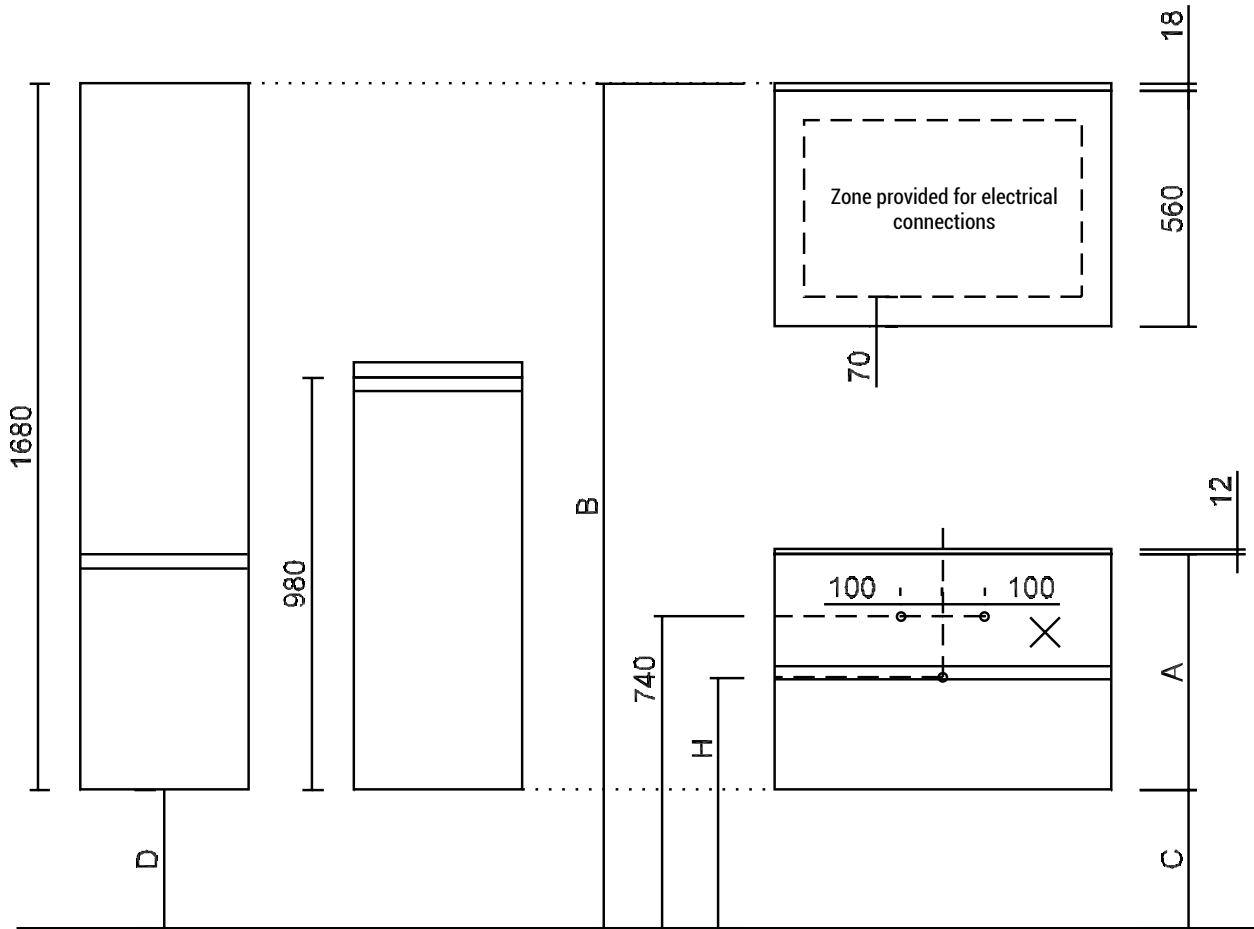

CAUTION! In the case of two washbasins, the water supply and drainage must be placed at the same height below the centre of each washbasin.

Top view washbasins solid surface - see p. 378

Solid surface (S2) - without overflow thickness 15mm - depth 460mm								
Type	A	B	C	D	E	F	G	H
Without grip	560	2008	328	328	285	425	555	655
Without grip	399	2008	489	328	285	425	555	710
Without grip	295	2008	593	328	285	425	555	710
Without grip	267	2008	621	328	285	425	555	710
FARM	532	2036	356	356	313	453	583	655
FARM	399	2036	489	356	313	453	583	710
FARM	267	2036	621	356	313	453	583	710

Without LED canopy, the distance E, F and G will be 18mm greater.

Solid surface (S2) - with overflow type XXAK177 thickness 15mm - depth 460mm								
Type	A	B	C	D	E	F	G	H
Without grip	560	2008	328	328	285	425	555	595
Without grip	399	2008	489	328	285	425	555	650
Without grip	295	2008	593	328	285	425	555	650
Without grip	267	2008	621	328	285	425	555	650
FARM	532	2036	356	356	313	453	583	595
FARM	399	2036	489	356	313	453	583	650
FARM	267	2036	621	356	313	453	583	650

Without LED canopy, the distance E, F and G will be 18mm greater.

SQUARE SOLID SURFACE (S3) - INSTALLATION DRAWING - FRONT AND SIDE VIEW

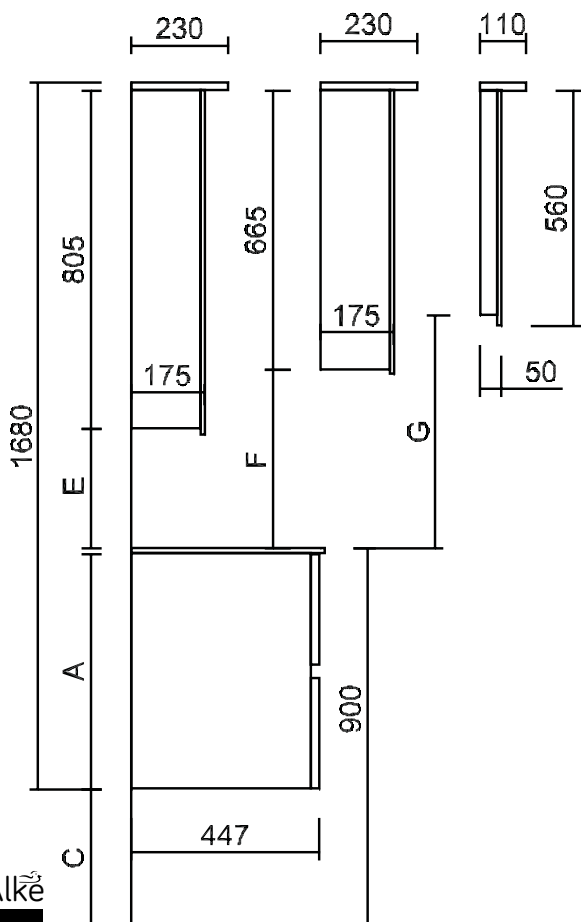
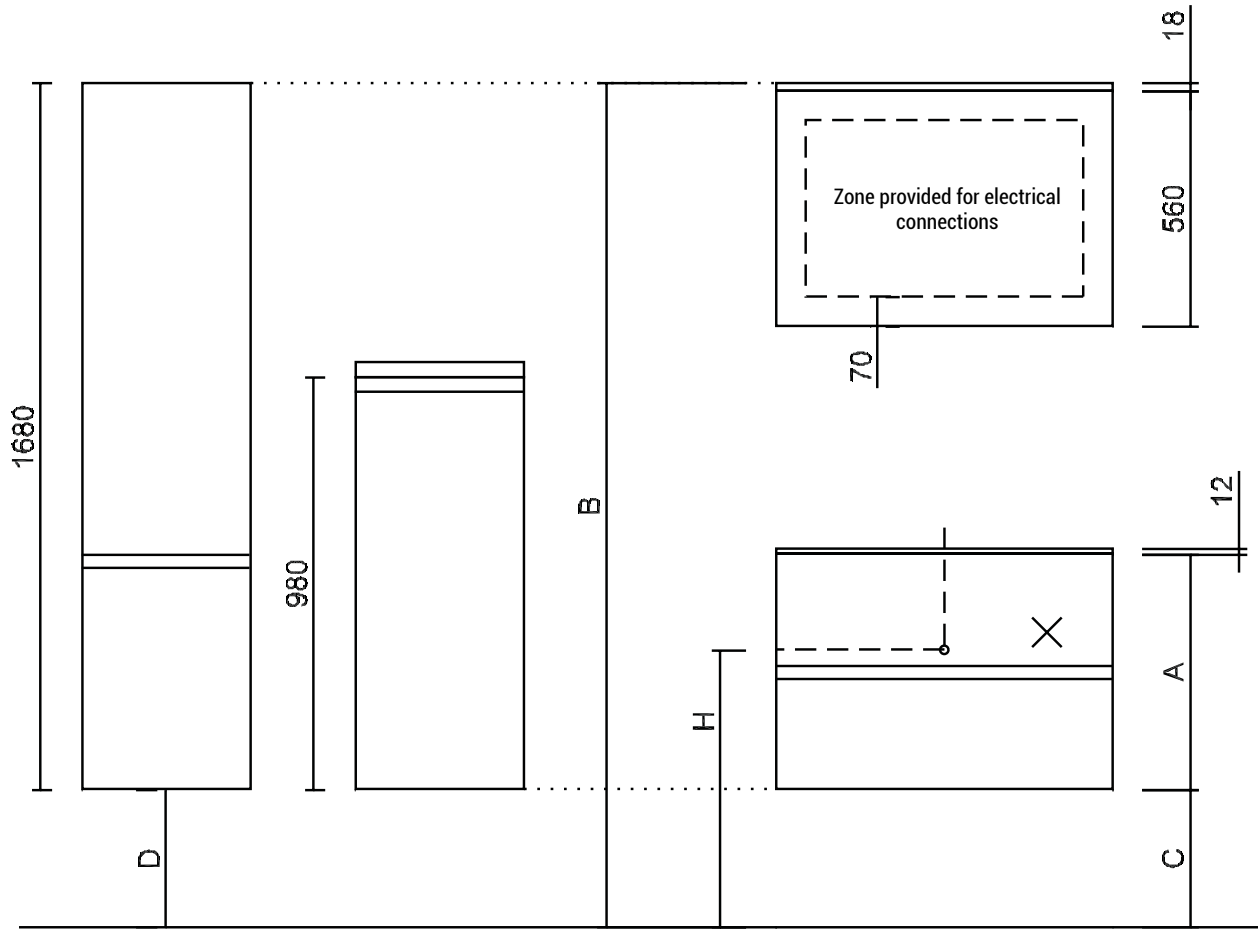

CAUTION! In the case of two washbasins, the water supply and drainage must be placed at the same height below the centre of each washbasin.

Top view washbasins solid surface - see p. 378

Solid surface (S3) thickness 15mm - depth 460mm								
Type	A	B	C	D	E	F	G	H
Without grip	560	2008	328	328	285	425	555	660
Without grip	399	2008	489	328	285	425	555	660
Without grip	295	2008	593	328	285	425	555	660
Without grip	267	2008	621	328	285	425	555	660
FARM	532	2036	356	356	313	453	583	660
FARM	399	2036	489	356	313	453	583	660
FARM	267	2036	621	356	313	453	583	660

Without LED canopy, the distance G and H will be 18mm greater.
S3 can only be combined with wall faucet or Water Mirror.

SQUARE SOLID SURFACE (S4) - INSTALLATION DRAWING - FRONT AND SIDE VIEW

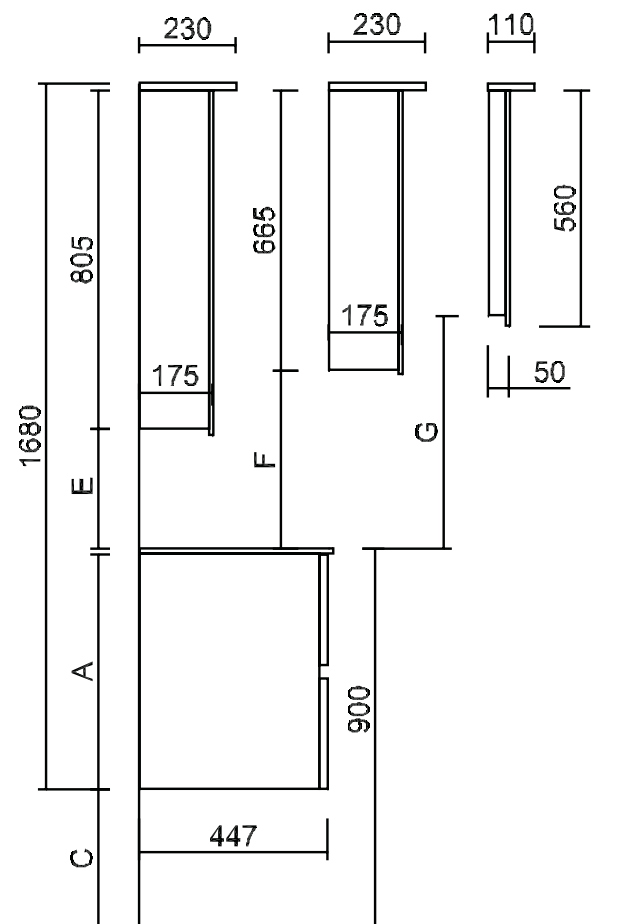
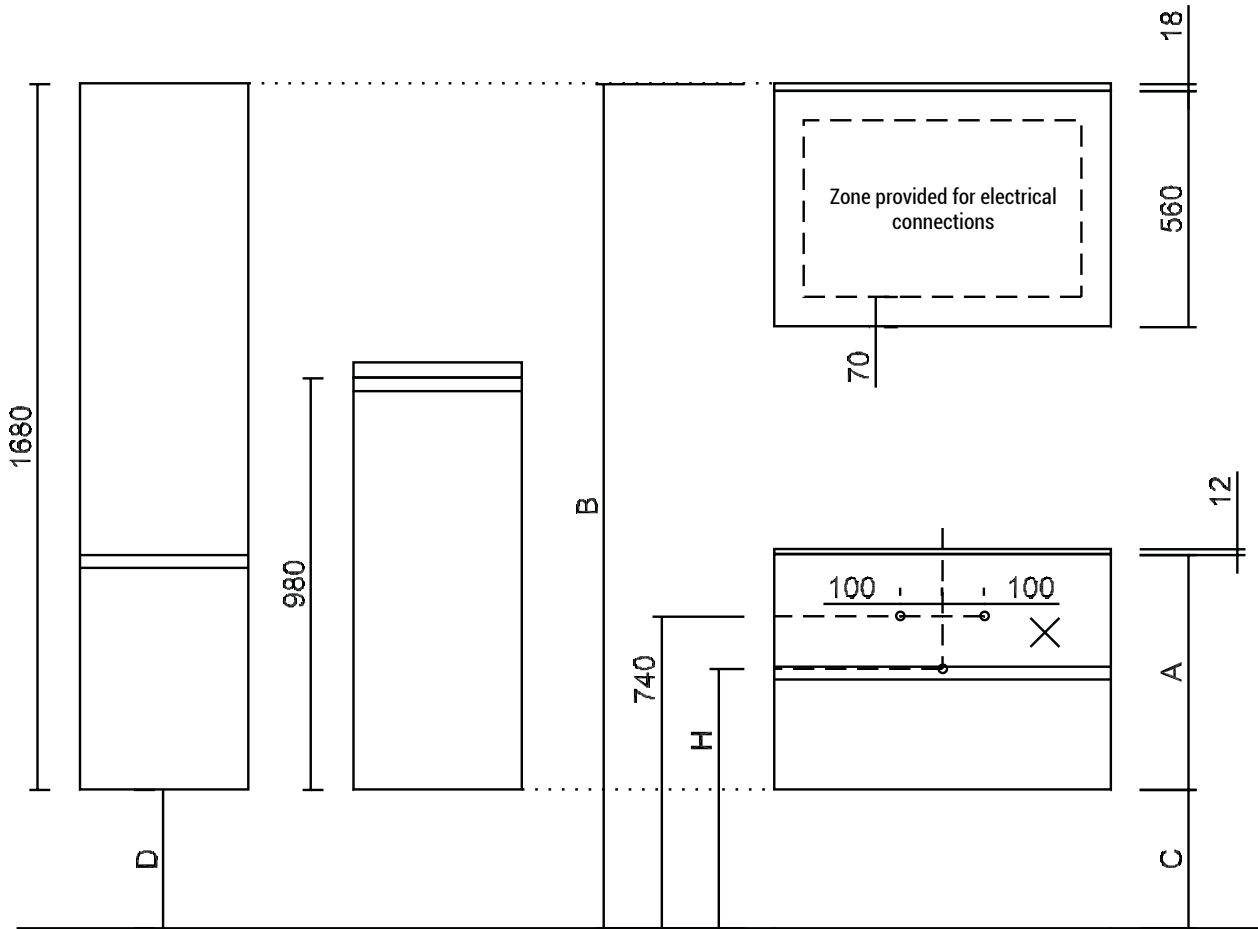

CAUTION! In the case of two washbasins, the water supply and drainage must be placed at the same height below the centre of each washbasin.

Top view washbasins solid surface - see p. 378

Solid surface (S4) - without overflow thickness 15mm - depth 460mm								
Type	A	B	C	D	E	F	G	H
Without grip	560	2008	328	328	285	425	555	675
Without grip	399	2008	489	328	285	425	555	730
Without grip	295	2008	593	328	285	425	555	730
Without grip	267	2008	621	328	285	425	555	730
FARM	532	2036	356	356	313	453	583	675
FARM	399	2036	489	356	313	453	583	730
FARM	267	2036	621	356	313	453	583	730

Without LED canopy, the distance E, F and G will be 18mm greater.

Solid surface (S4) - with overflow type XXAK177 thickness 15mm - depth 460mm								
Type	A	B	C	D	E	F	G	H
Without grip	560	2008	328	328	285	425	555	615
Without grip	399	2008	489	328	285	425	555	670
Without grip	295	2008	593	328	285	425	555	670
Without grip	267	2008	621	328	285	425	555	670
FARM	532	2036	356	356	313	453	583	615
FARM	399	2036	489	356	313	453	583	670
FARM	267	2036	621	356	313	453	583	670

Without LED canopy, the distance E, F and G will be 18mm greater.

SQUARE SOLID SURFACE (S5) - INSTALLATION DRAWING - FRONT AND SIDE VIEW

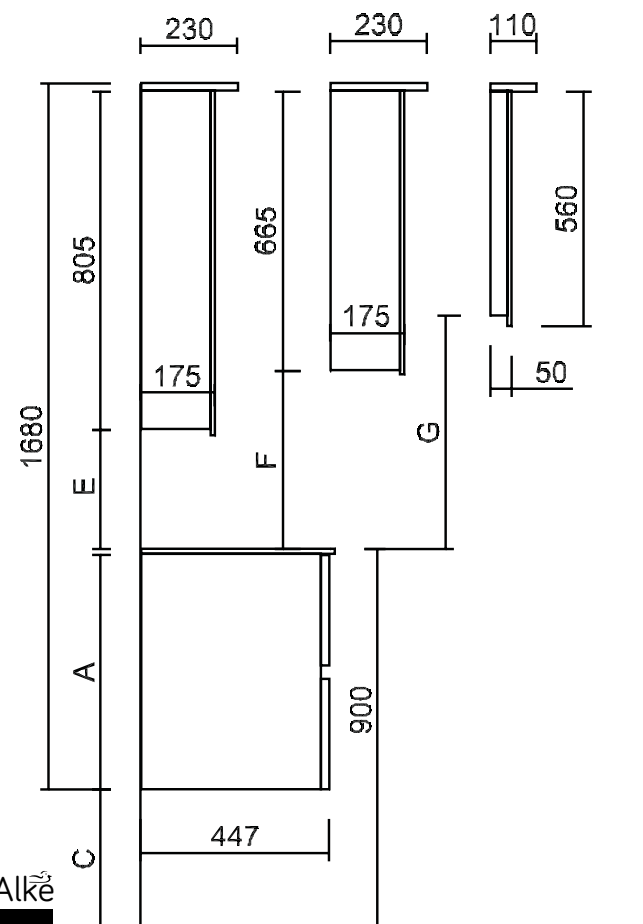
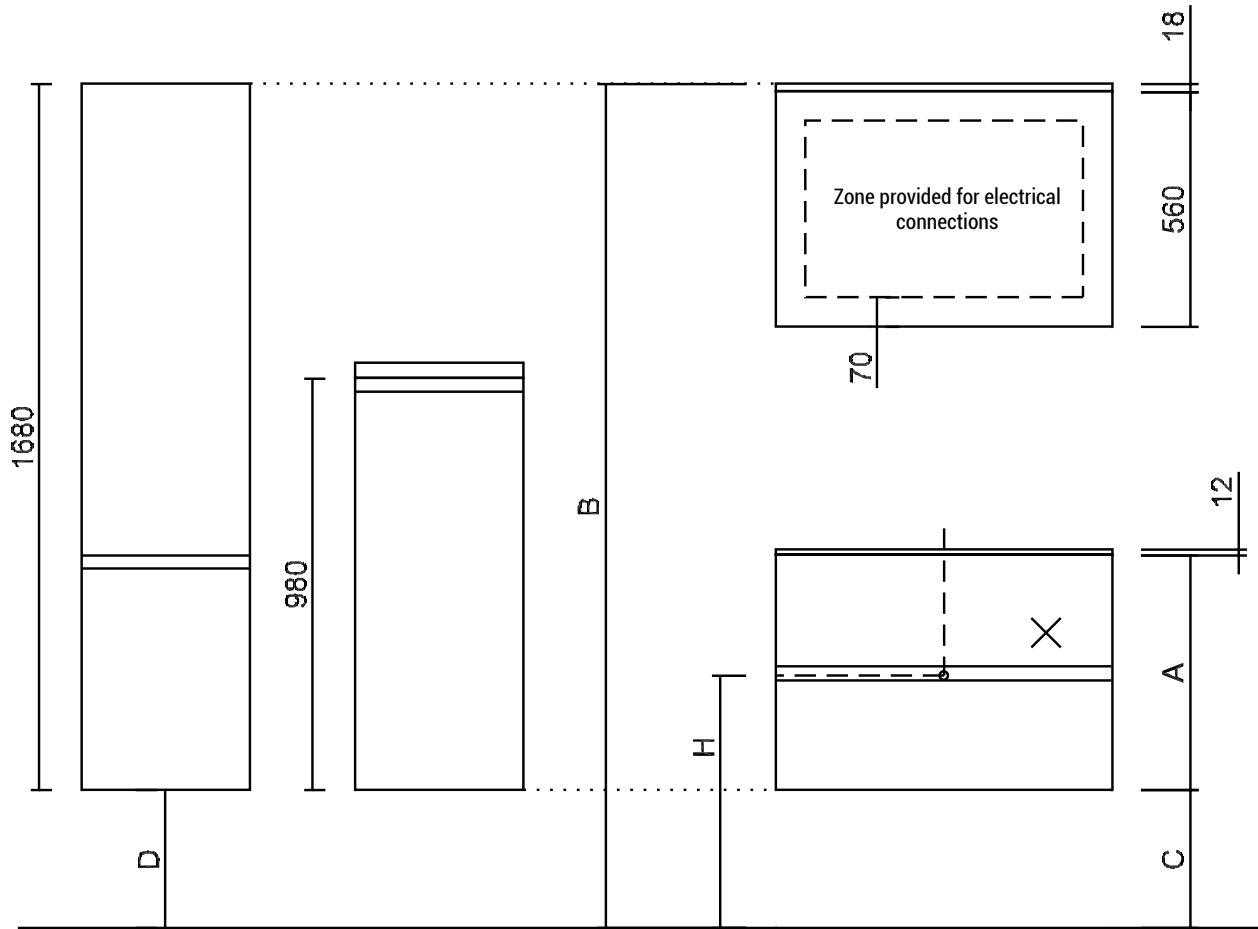

CAUTION! In the case of two washbasins, the water supply and drainage must be placed at the same height below the centre of each washbasin.

Top view washbasins solid surface - see p. 378

Solid surface (S5) - without overflow
thickness 15mm - depth 460mm

Type	A	B	C	D	E	F	G	H
Without grip	560	2008	328	328	285	425	555	660
Without grip	399	2008	489	328	285	425	555	710
Without grip	295	2008	593	328	285	425	555	710
Without grip	267	2008	621	328	285	425	555	710
FARM	532	2036	356	356	313	453	583	660
FARM	399	2036	489	356	313	453	583	710
FARM	267	2036	621	356	313	453	583	710

Without LED canopy, the distance E, F and G will be 18mm greater.
S5 only combinable with wall tap or Water Mirror.

Solid surface (S5) - with overflow
type XXAK177 thickness 15mm - depth 460mm

Type	A	B	C	D	E	F	G	H
Without grip	560	2008	328	328	285	425	555	600
Without grip	399	2008	489	328	285	425	555	655
Without grip	295	2008	593	328	285	425	555	655
Without grip	267	2008	621	328	285	425	555	655
FARM	532	2036	356	356	313	453	583	600
FARM	399	2036	489	356	313	453	583	655
FARM	267	2036	621	356	313	453	583	655

Without LED canopy, the distance E, F and G will be 18mm greater.
S5 only combinable with wall tap or Water Mirror.

SQUARE SOLID SURFACE (S6) - INSTALLATION DRAWING - FRONT AND SIDE VIEW

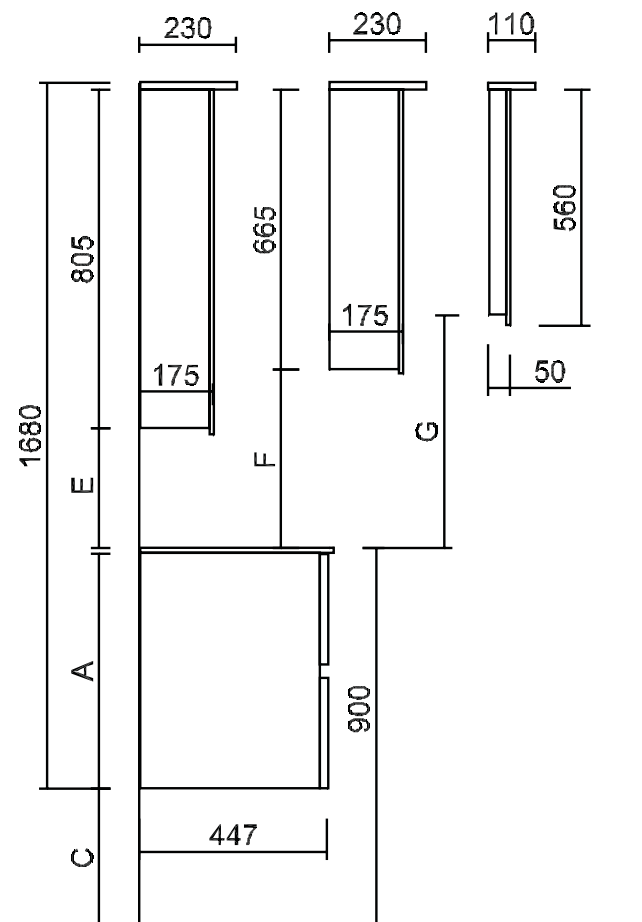
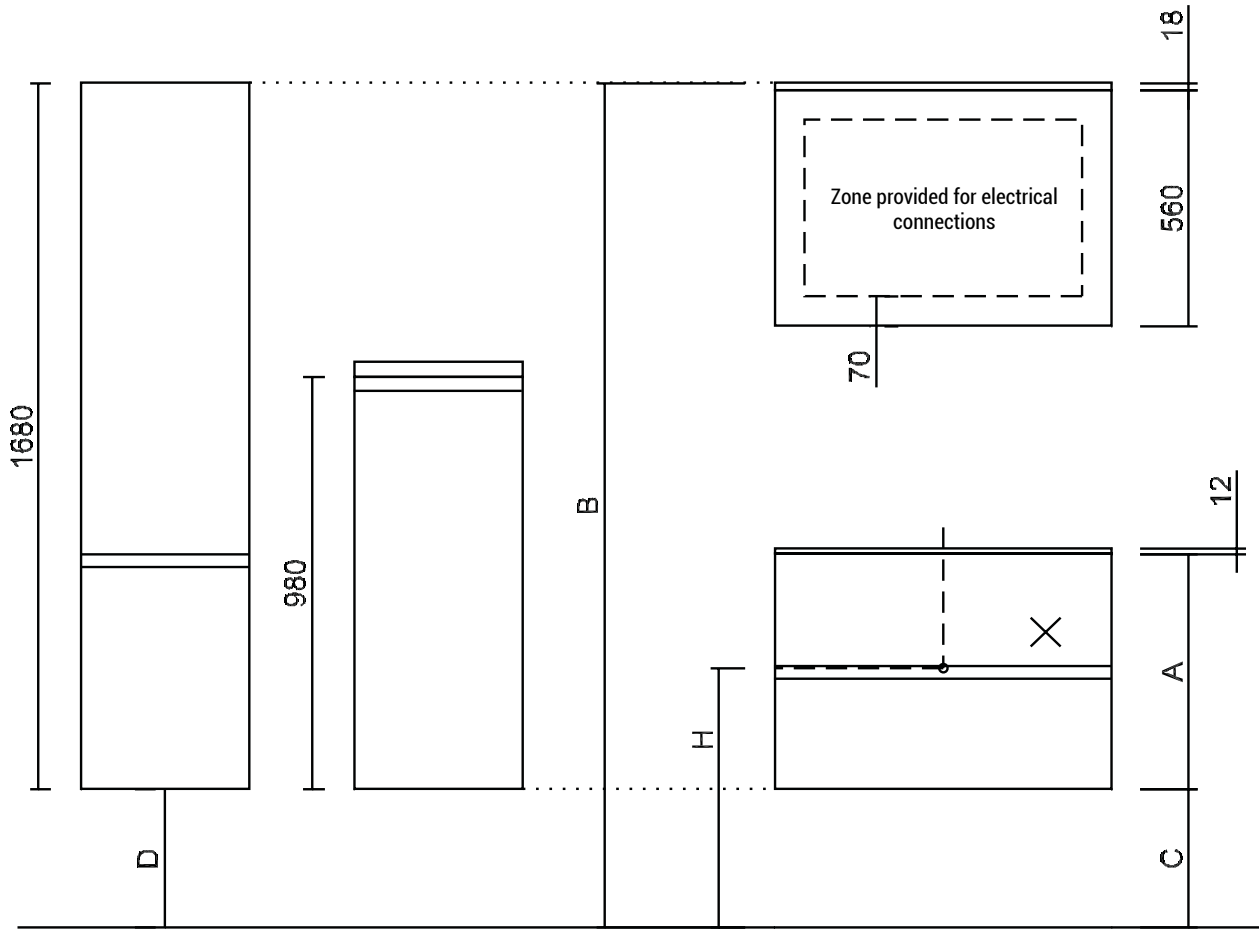

CAUTION! In the case of two washbasins, the water supply and drainage must be placed at the same height below the centre of each washbasin.

Top view washbasins solid surface - see p. 378

Solid surface (S6) - without overflow thickness 15mm - depth 460mm								
Type	A	B	C	D	E	F	G	H
Without grip	560	2008	328	328	285	425	555	655
Without grip	399	2008	489	328	285	425	555	705
Without grip	295	2008	593	328	285	425	555	705
Without grip	267	2008	621	328	285	425	555	705
FARM	532	2036	356	356	313	453	583	655
FARM	399	2036	489	356	313	453	583	705
FARM	267	2036	621	356	313	453	583	705

Without LED canopy, the distance G and H will be 18mm greater.
S6 only combinable with wall tap or Water Mirror.

Solid surface (S6) - with overflow type XXAK177 thickness 15mm - depth 460mm								
Type	A	B	C	D	E	F	G	H
Without grip	560	2008	328	328	285	425	555	615
Without grip	399	2008	489	328	285	425	555	670
Without grip	295	2008	593	328	285	425	555	670
Without grip	267	2008	621	328	285	425	555	670
FARM	532	2036	356	356	313	453	583	615
FARM	399	2036	489	356	313	453	583	670
FARM	267	2036	621	356	313	453	583	670

Without LED canopy, the distance E, F and G will be 18mm greater.
S6 only combinable with wall tap or Water Mirror.

SQUARE SOLID SURFACE (S7) - INSTALLATION DRAWING - FRONT AND SIDE VIEW

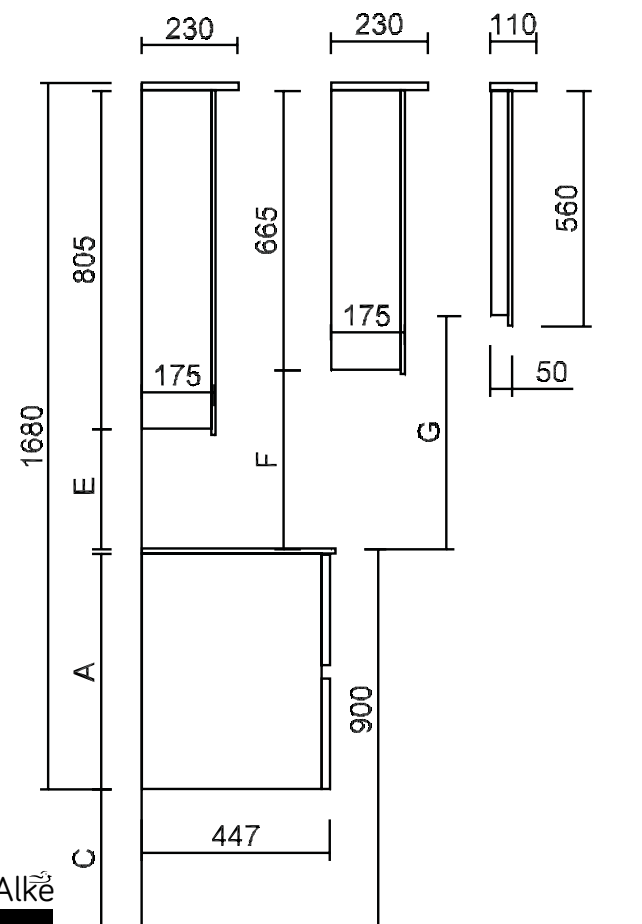
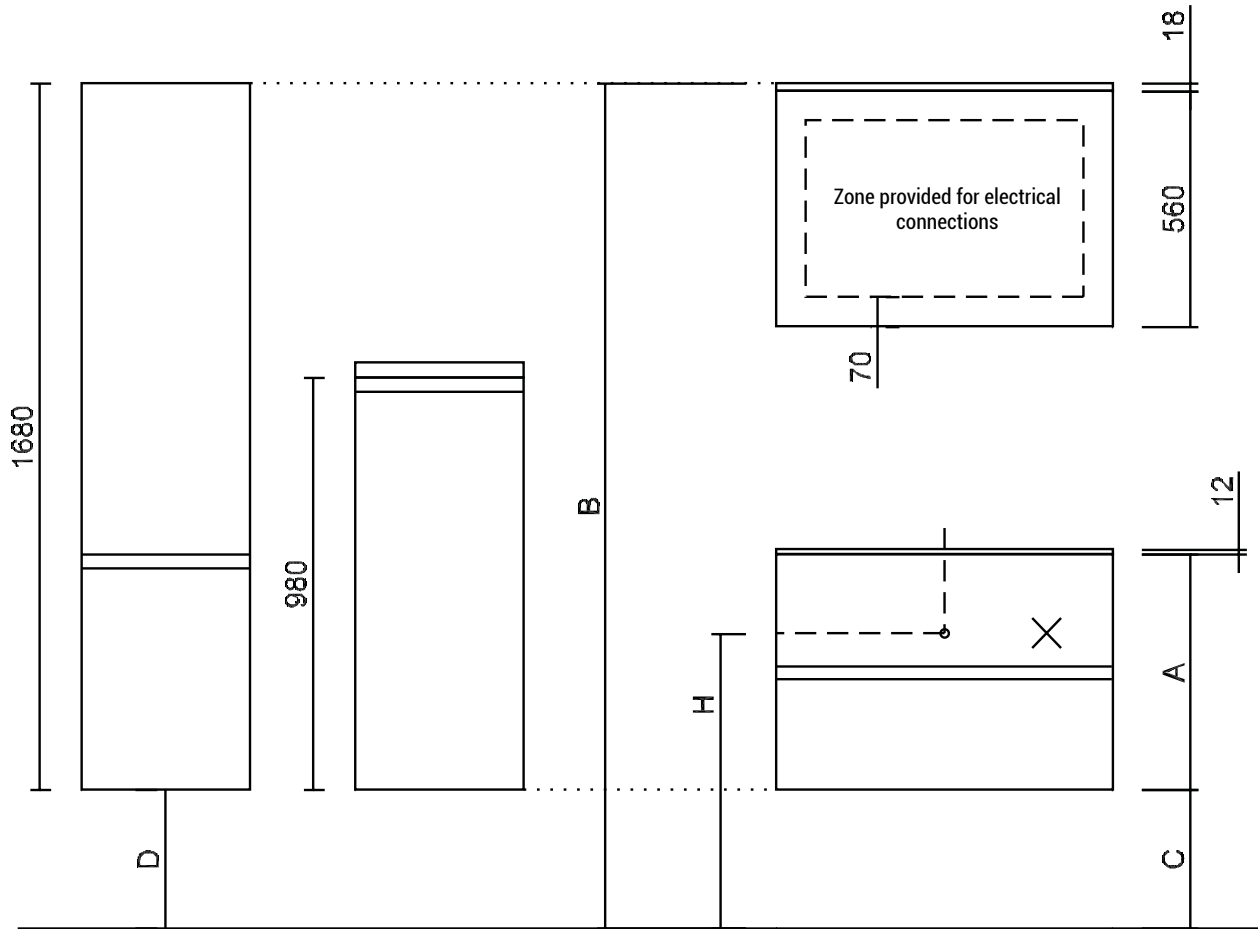

CAUTION! In the case of two washbasins, the water supply and drainage must be placed at the same height below the centre of each washbasin.

Top view washbasins solid surface - see p. 378

Solid surface (S7) thickness 15mm - depth 460mm								
Type	A	B	C	D	E	F	G	H
Without grip	560	2008	328	328	285	425	555	700
Without grip	399	2008	489	328	285	425	555	755
Without grip	295	2008	593	328	285	425	555	755
Without grip	267	2008	621	328	285	425	555	755
FARM	532	2036	356	356	313	453	583	700
FARM	399	2036	489	356	313	453	583	755
FARM	267	2036	621	356	313	453	583	755

Without LED canopy, the distance E, F and G will be 18mm greater.
S6 only combinable with wall tap or Water Mirror.

SQUARE SOLID SURFACE (S1/S2/S3/S4/S5/S6/S7) - TOP VIEW WASHBASINS

A type XXAK 177 overflow system is supplied as standard with Solid Surface washbasins in types S1, S2, S4 and W5. Combine preferably with a compact XXAK 134 type siphon (see fold-out cover at the back).

Types S6 and S7 washbasins come as standard with a pop-up drain plug without overflow of the type XXAK184 (see p. 330).

L = cabinet size + 5mm

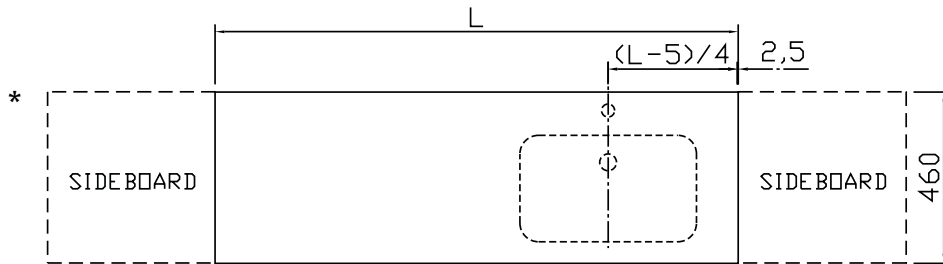
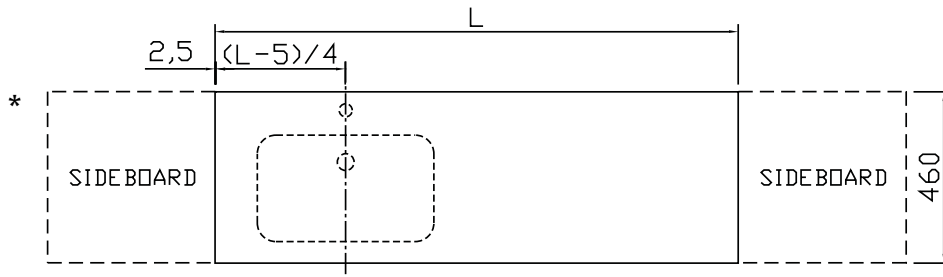
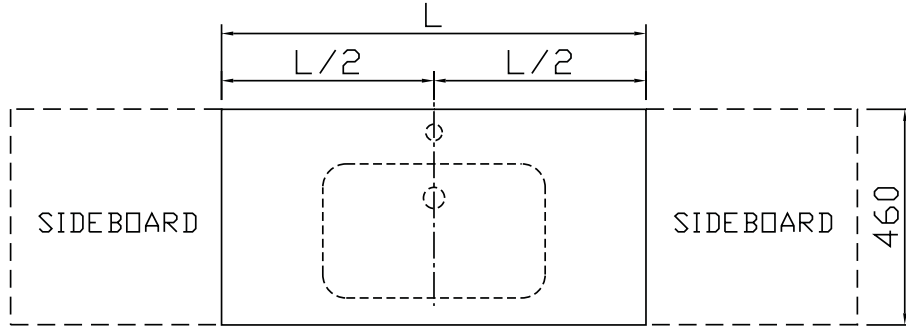

* Not for 90 mm wide washbasins.

