

QUADRO CERAMIC (C1) - INSTALLATION DRAWING - FRONT AND SIDE VIEW

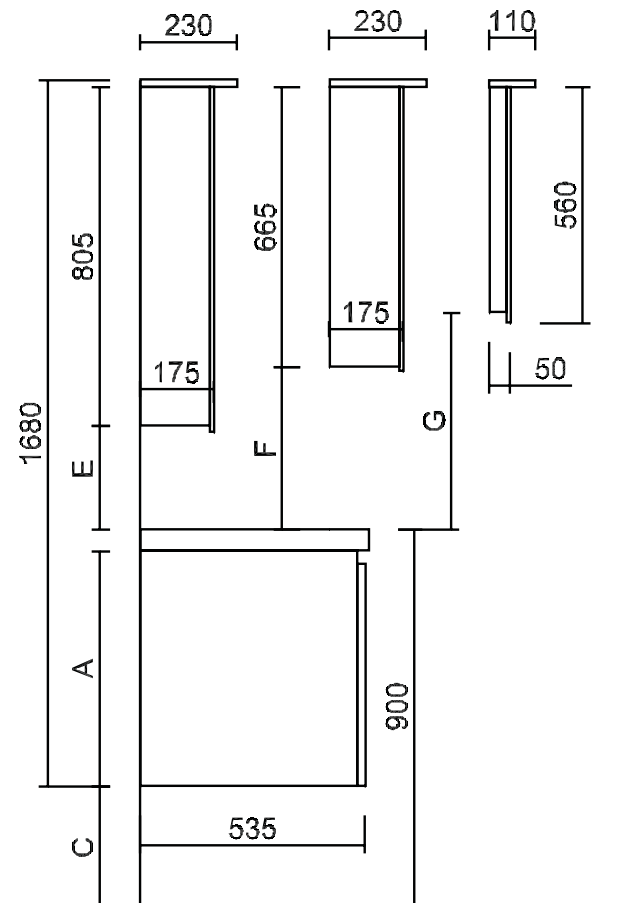
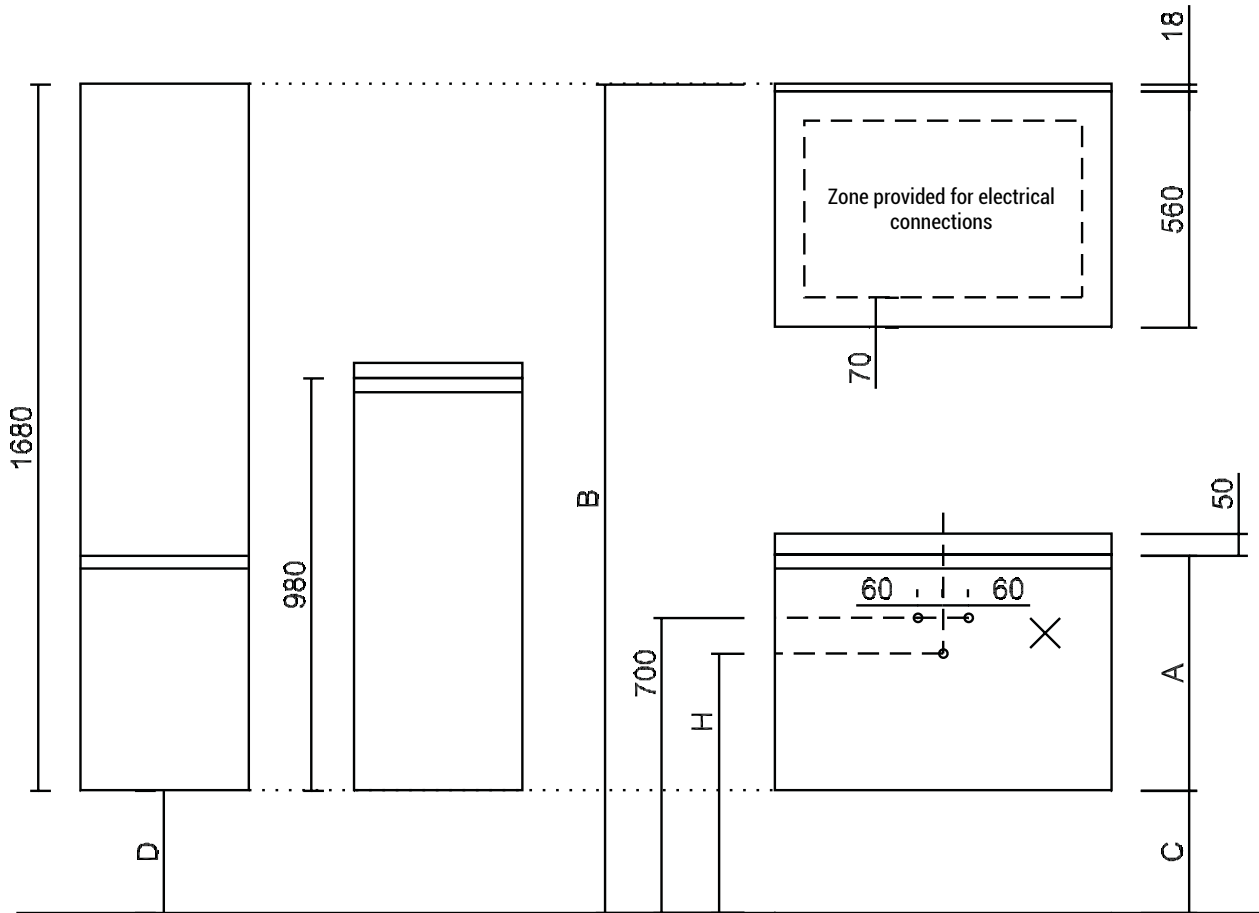

CAUTION! In the case of two washbasins, the water supply and drainage must be placed at the same height below the centre of each washbasin

Ceramic (C1) thickness 50mm - depth 543mm								
Type	A	B	C	D	E	F	G	H
Without grip	560	1970	290	290	247	387	517	615
Without grip	427	1970	423	290	247	387	517	615
Without grip	295	1970	555	290	247	387	517	615
FARM	532	1998	318	318	275	415	545	615
FARM	399	1998	451	318	275	415	545	615
FARM	267	1998	583	318	275	415	545	615

Without LED canopy, the distance E, F and G will be 18mm greater.

QUADRO CERAMIC (C1) - TOP VIEW WASHBASINS

This type of washbasin is fitted with a built-in overflow.

