

TECHNICAL INFORMATION - SQUARE 460MM F26

SQUARE MINERAL MARBLE (M8) - installation drawing - front and side view

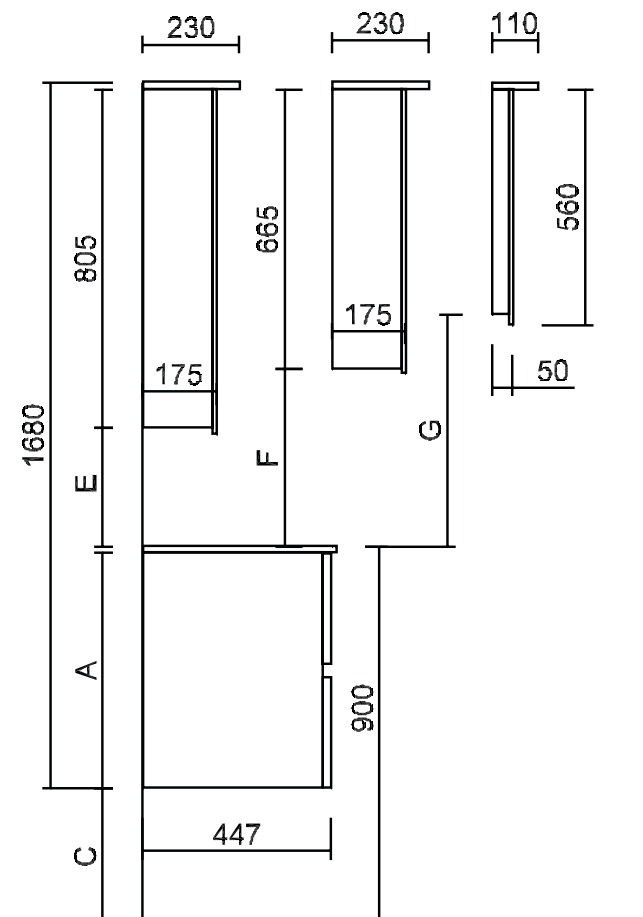
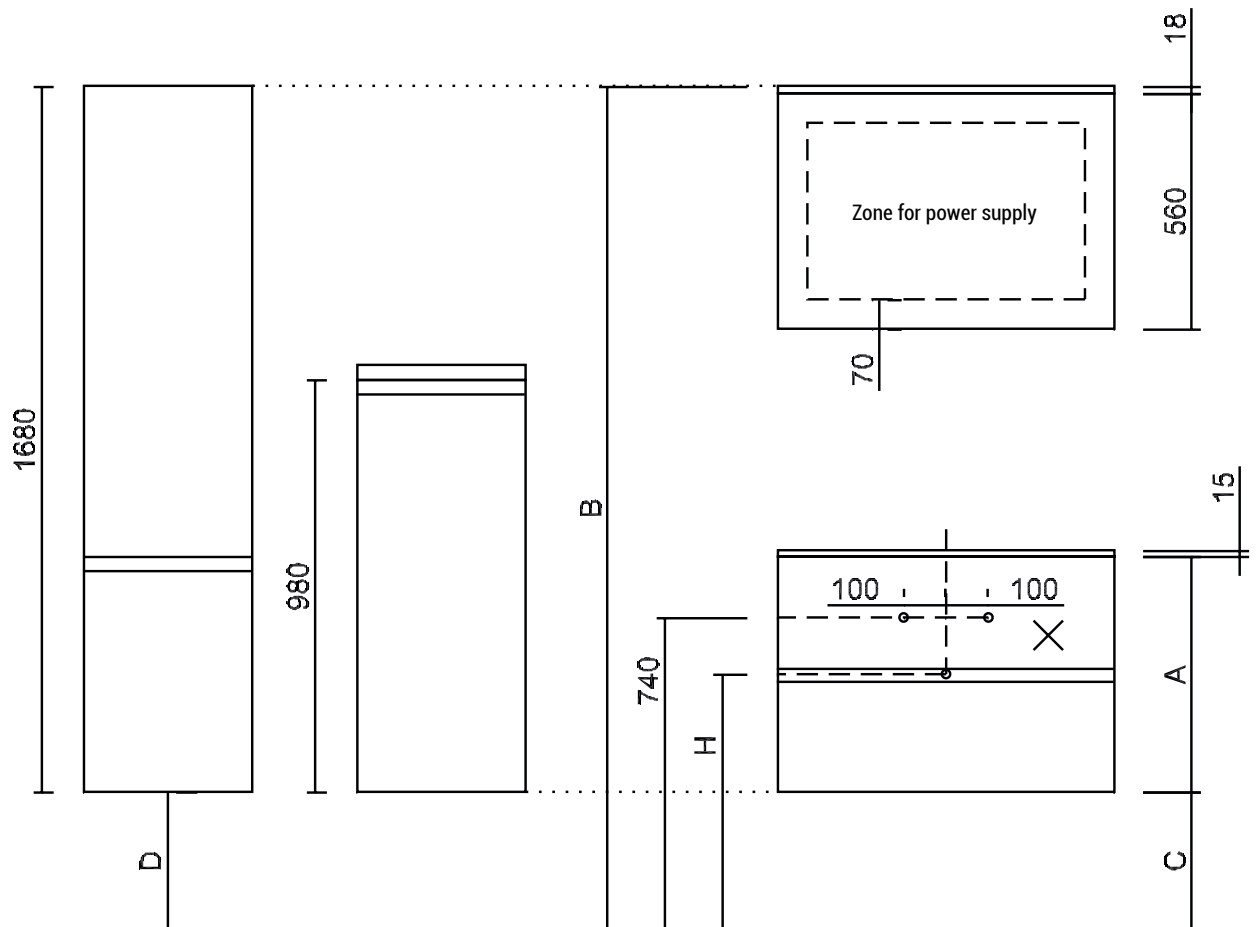

CAUTION! In the case of two washbasins, the water supply and drainage must be placed at the same height below the centre of each washbasin.

Mineral marble (M8) thickness 15mm - depth 460mm								
Type	A	B	C	D	E	F	G	H
Without grip	560	2005	325	325	282	422	552	605
Without grip	399	2005	486	325	282	422	552	650
Without grip	267	2005	618	325	282	422	552	650

Without LED canopy, the distance E, F and G will be 18mm greater.

TECHNICAL INFORMATION - SQUARE 460MM F26

SQUARE MINERAL MARBLE (M8) - top view washbasins

This type of washbasin is fitted with a built-in overflow.

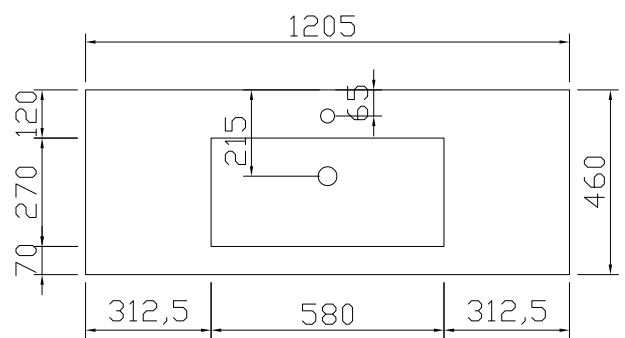
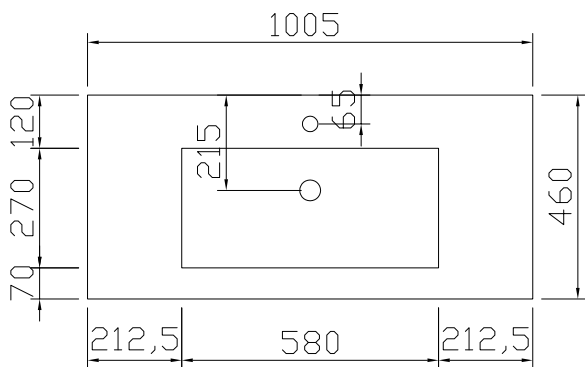
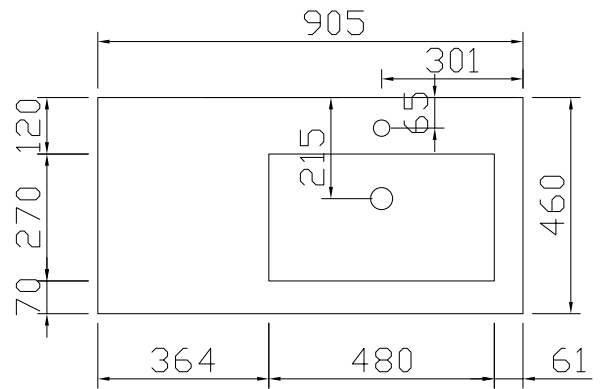
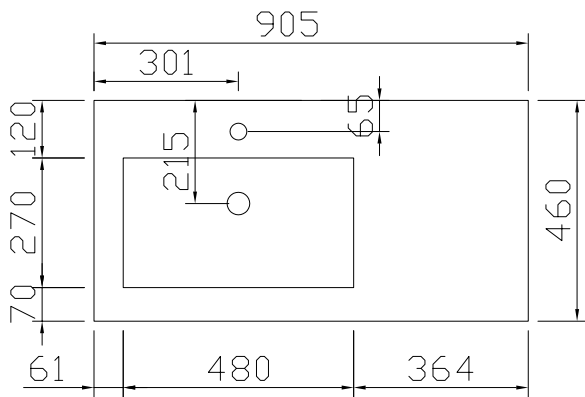
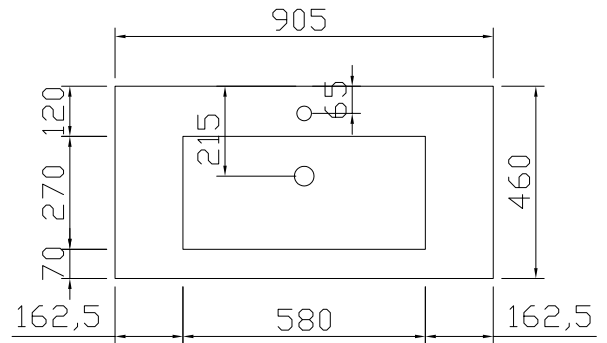
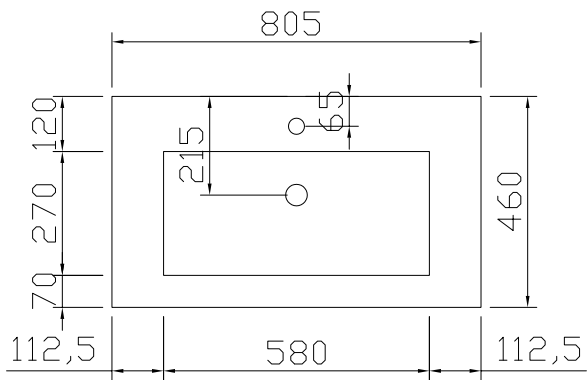

TECHNICAL INFORMATION - SQUARE 460MM F26

SQUARE MINERAL MARBLE (M8) - top view washbasins

This type of washbasin is fitted with a built-in overflow.

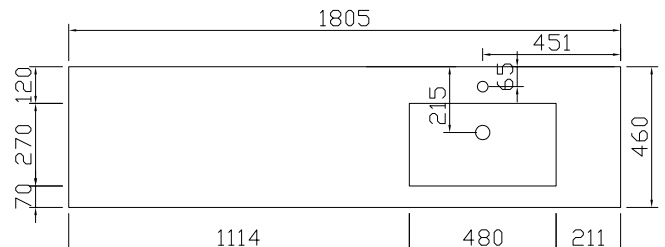
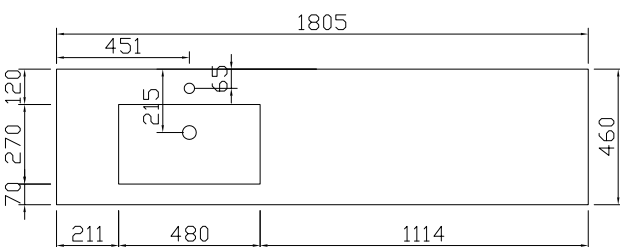
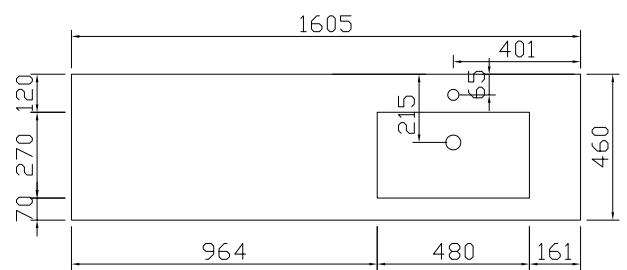
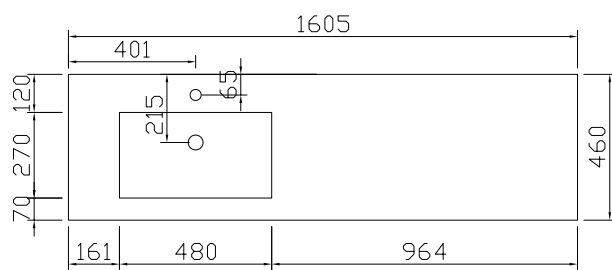
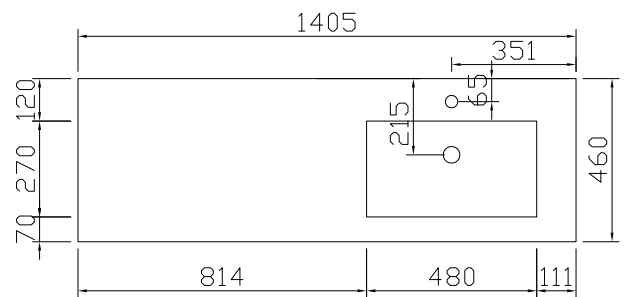
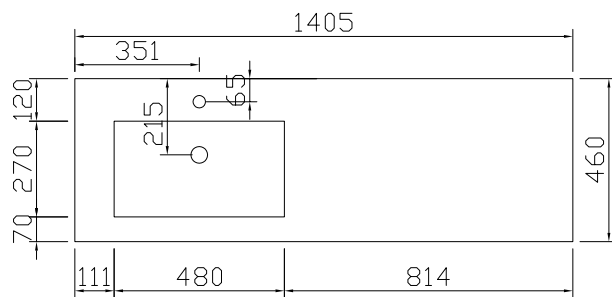
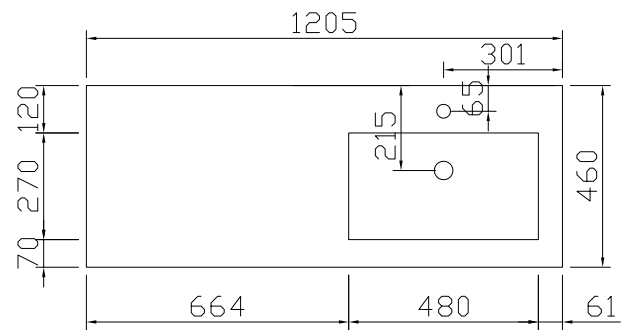
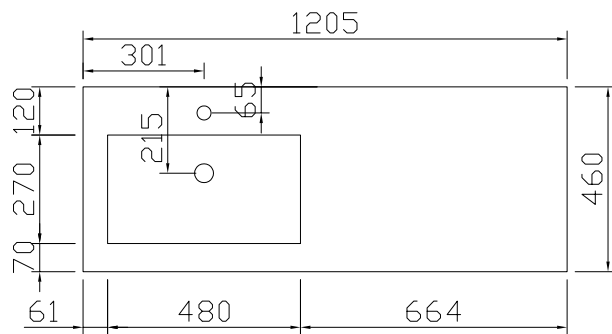
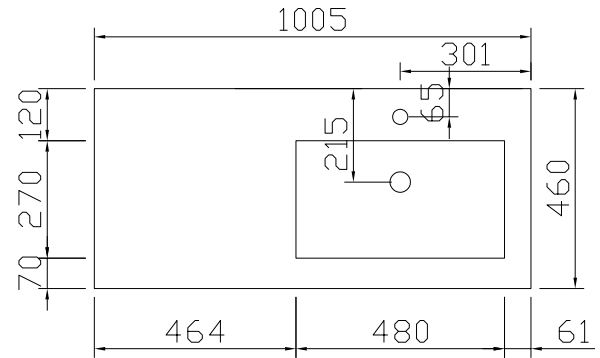
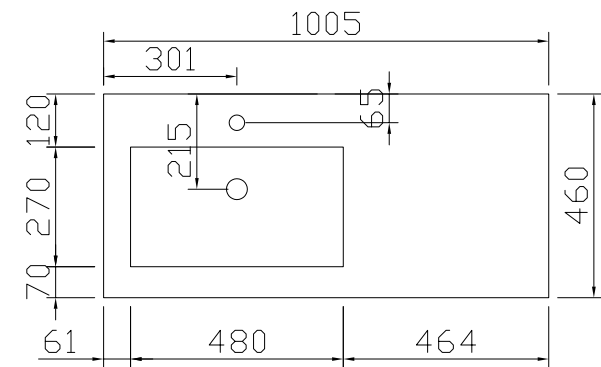

TECHNICAL INFORMATION - SQUARE 460MM F26

SQUARE MINERAL MARBLE (M8)- top view washbasins

This type of washbasin is fitted with a built-in overflow.

